

Existing Second Floor Plan / Roof Plan

Scale 1:200

Revision	Date	Description	Issued	Checked
P1	31.05.2024	Part 8 Planning Application to Kildare County Council	AOD	DM
P2	04.06.2024	Part 8 Planning Application Revisions		



Notes
 Do not scale drawings. All dimensions should be checked on site. Errors to be reported to Architect. To be read in conjunction with all relevant Architect's services and engineers's drawings. Contractors, sub-contractors and suppliers must verify any critical dimensions on site prior to fabrication of any building element. Any discrepancies are to be reported to the Architect. This drawing should be read in conjunction with all relevant specifications, engineers and specialist consultant's information. Any discrepancies must be reported prior to installation.
 No information in this drawing/specification should be interpreted as design related to fire safety or fire performance. As required by the Professional Indemnity market we exclude any liability whatsoever for the fire safety of buildings, products, materials or systems and assume these will be by others such as a Fire Engineer and Specialist Contractor Design.
Copyright
 Copyright Metropolitan Workshop LLP
 No implied license exists. This drawing should not be used to calculate areas for the purpose of valuation. Do not scale this drawing. All dimensions to be checked on site by the contractor and such dimensions to be their (his/her) responsibility. All work must comply with the relevant British Standards and Building Regulations. Drawing's error and omissions to be reported to the architect.
 This drawing was prepared in part, based on survey information provided by others. Whilst this information is believed to be reliable, Metropolitan Workshop assumes no responsibility for the accuracy of this information or any errors or omissions that may have been incorporated into it as a result of incorrect information provided by others.

Key

- N North Point
- Existing Fabric
- Existing Fabric to be Removed
- Existing Hedgerow
- Existing Hedgerow to be removed

- Building A1 - North Dovecote
- Building A2 - South Dovecote
- Building B1 - The Wonderful Barn
- Building B2 - Potato House
- Building C - Barnhall House
- Building D1 - East Stable
- Building D2 - West Stable
- Courtyard 1
- Courtyard 2
- Courtyard 3

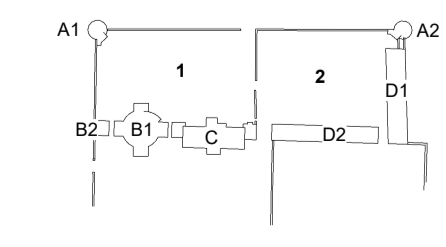

Metropolitan Workshop
 Metropolitan Workshop
 Tower 2, Fumbally Lane, Dublin
 D08 N2N6
 00 353 (0)1 531 4889
 www.metwork.ie

Project:	The Wonderful Barn							
Client:	Kildare County Council							
Location:	Leixlip, Co. Kildare							
Title:	Existing Second Floor Plan / Roof Plan							
Date:	04.06.2024							
Scale:	As indicated @ A1							
Drawing Number:	2123							
Project	Originator	Volume	Level	Type	Role	Reference	Suitability	Revision
2123	MET	ZZ	02	DR	A	091003	S4	P2

MW BIM Suitability Codes: A1, A2, An, etc. - Approved and accepted as Stage Complete, B1, B2, Bn, etc. - Partially signed-off, CR - As Construction Record documentation, S0 - Initial status or WP, S1 - Suitable for Coordination, S2 - Suitable for Information, S3 - Suitable for Review & Comment, S4 - Suitable for Stage Approval, S5 - Suitable for PM Authorisation (Information Exchanges 1-5), S7 - Suitable for AM Authorisation (Information Exchange 6)