

NO PART OF THIS DRAWING MAY BE REPRODUCED OR TRANSMITTED IN ANY FORM OR STORED IN ANY RETRIEVAL SYSTEM OF ANY NATURE WITHOUT THE WRITTEN PERMISSION OF MALONE O'REGAN CONSULTING ENGINEERS AS COPYRIGHT HOLDER EXCEPT AS AGREED FOR USE ON THE PROJECT FOR WHICH THE DRAWING WAS ORIGINALLY CREATED.

THIS DRAWING IS TO BE READ IN CONJUNCTION WITH ALL OTHER RELEVANT DRAWINGS, SPECIFICATIONS AND THE PRELIMINARY HEALTH & SAFETY PLAN.

ALL DIMENSIONS ARE IN MM UNLESS NOTED OTHERWISE. DO NOT SCALE DIMENSIONS.

THE CONTRACTOR SHALL CHECK ALL DIMENSIONS PRIOR TO THE COMMENCEMENT OF CONSTRUCTION. ALL DISCREPANCIES SHALL BE REPORTED TO THIS OFFICE IN WRITING.

NOTES

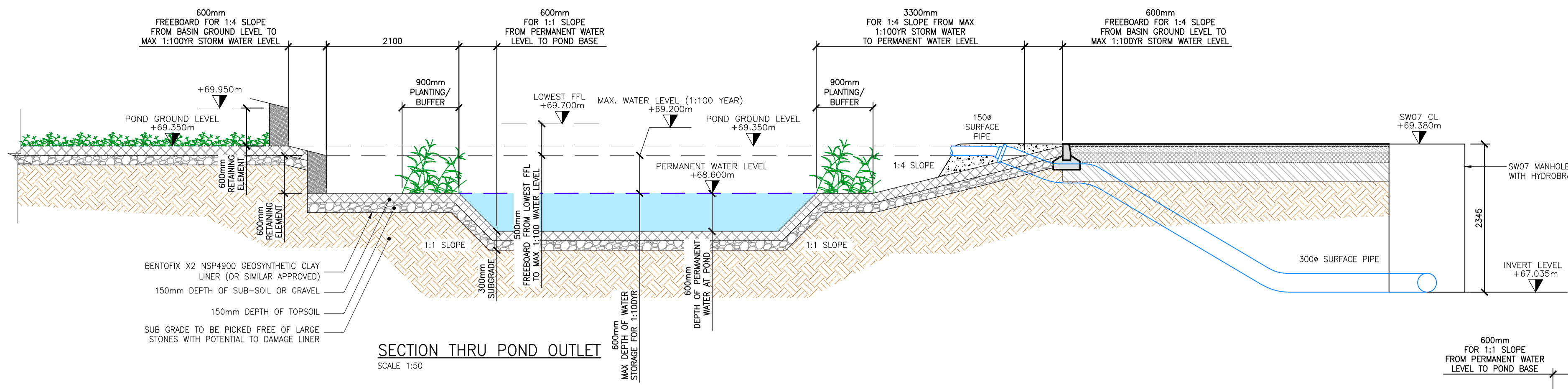

ATTENUATION POND
 LOWEST FFL = 69.700m
 500mm FREEBOARD i.e. 1:100 YEAR WATER LEVEL = 69.200m

GULLY CHECK
 LOWEST ROAD LEVEL = 69.350m
 150mm FREEBOARD FROM 1:100 YEAR WATER LEVEL

SIDE SLOPE = 1:4
 POND GROUND LEVEL = 69.350m
 LEVEL AT BASE OF POND = 68.000m

TOP AREA OF BASIN AT 1:100YR STORM WATER = 514.39m²
 BOTTOM AREA OF BASIN AT 1:100YR STORM WATER = 234.72m²
 AVERAGE AREA = 374.56m²
 1:100YR STORM VOLUME PROVIDED = 374.56m² x 0.60m = 224.73m³
 1:100YR STORM VOLUME REQUIRED = 190.550m³

REFER TO DRG. NO.150 FOR ATTENUATION POND LAYOUT

SECTION THRU POND OUTLET
 SCALE 1:50

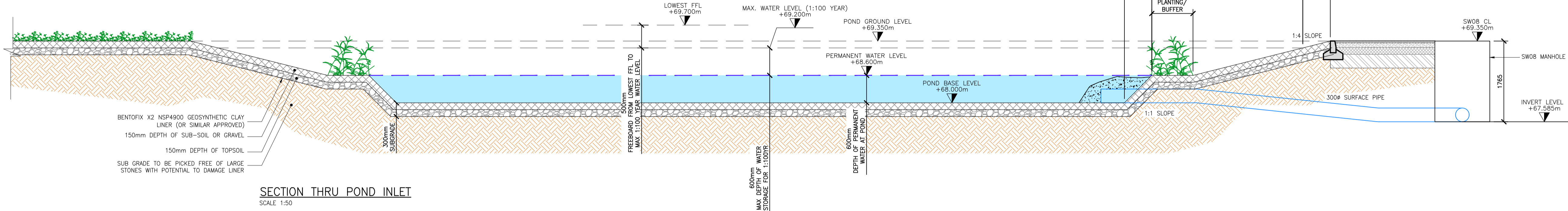

SECTION THRU POND INLET
 SCALE 1:50



FOOTPATH CONSTRUCTION
 100mm GRADE C32/40 CONCRETE WITH 1 LAYER A142 MESH ON 200mm CLAUSE 808 HARDCORE

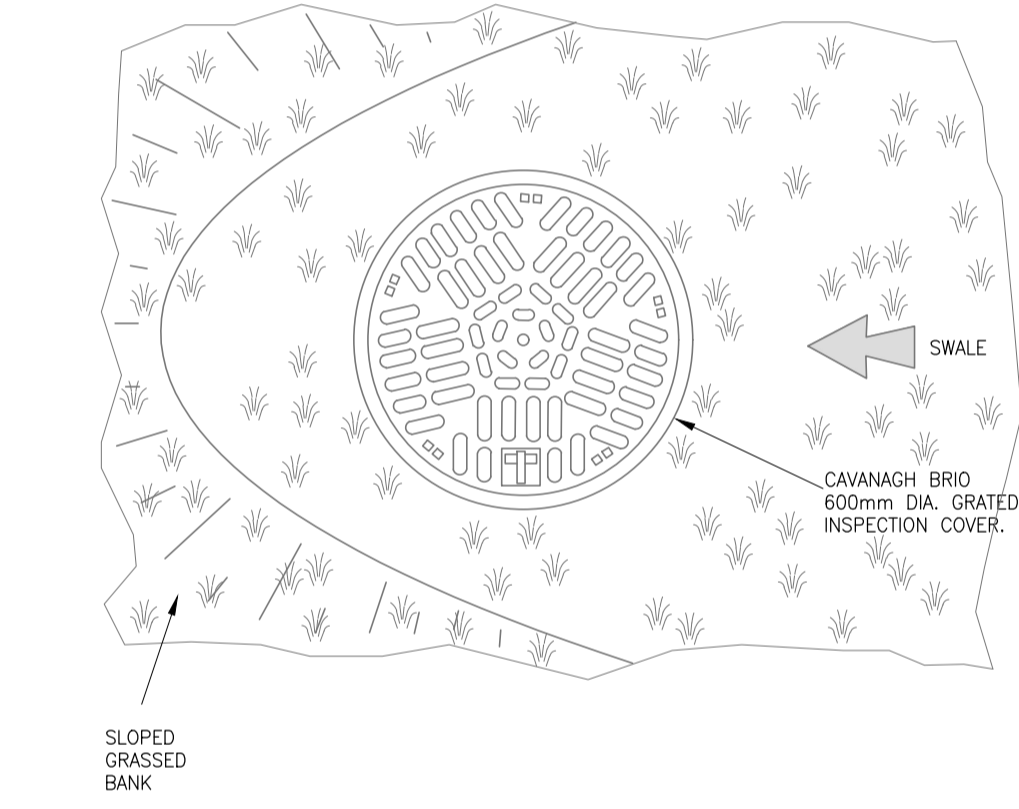

GRATED MANHOLE PLAN DETAIL D.
 SCALE: N.T.S.

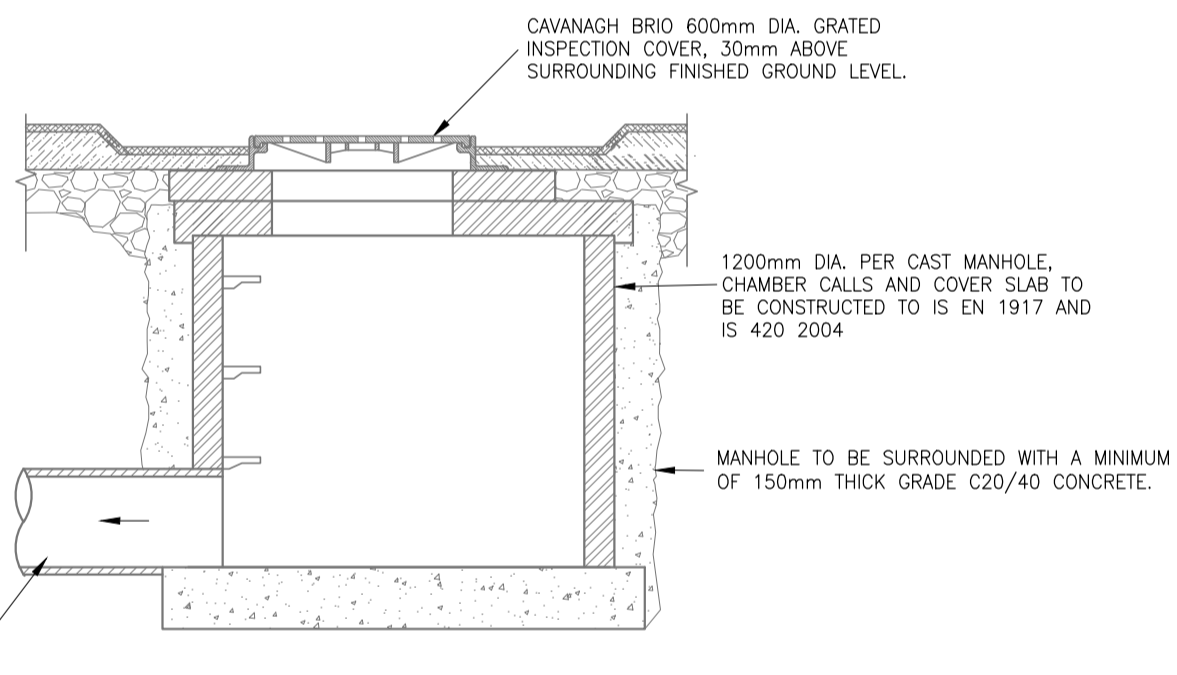

GRATED MANHOLE INLET CHAMBER - CROSS-SECTION
 SCALE: N.T.S.

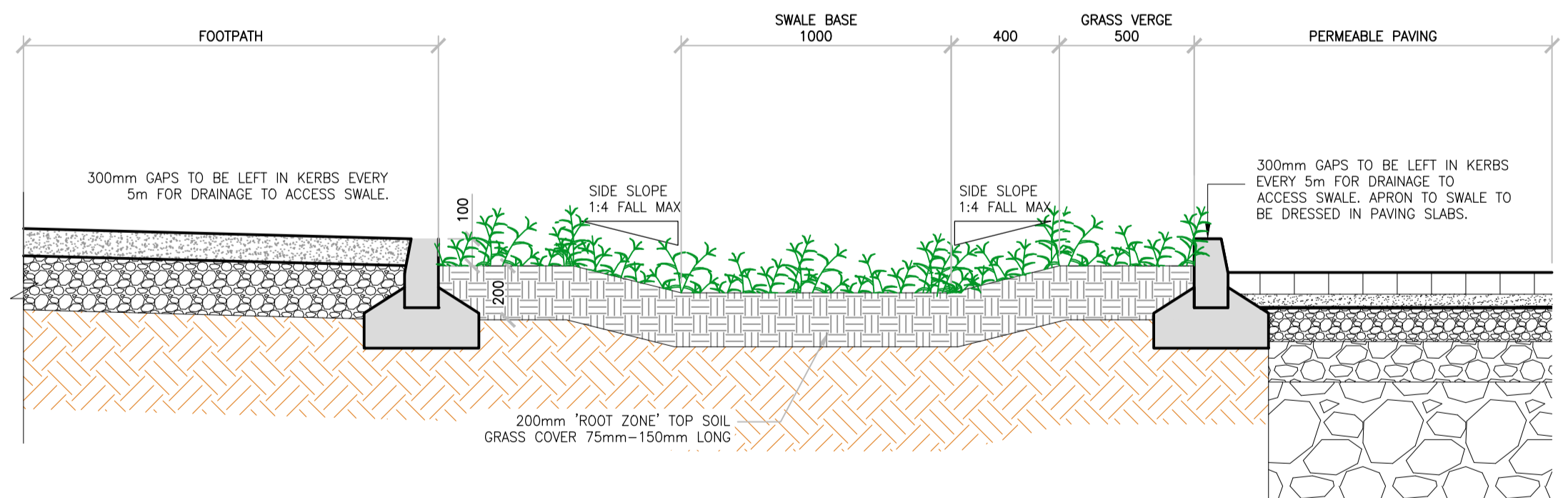

TYPICAL SECTION THROUGH WET SWALE TAKING DRAINAGE FROM A HARDSTANDING AREA
 SCALE 1:20

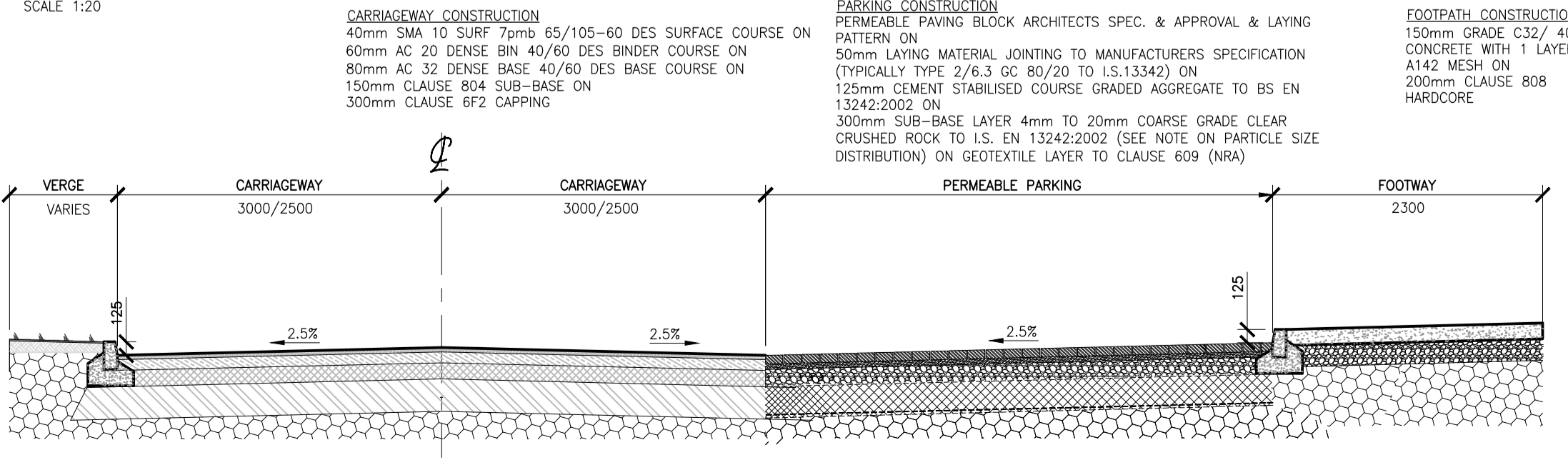

TYPICAL CROSS SECTION THROUGH ESTATE ROADS
 SCALE 1:30

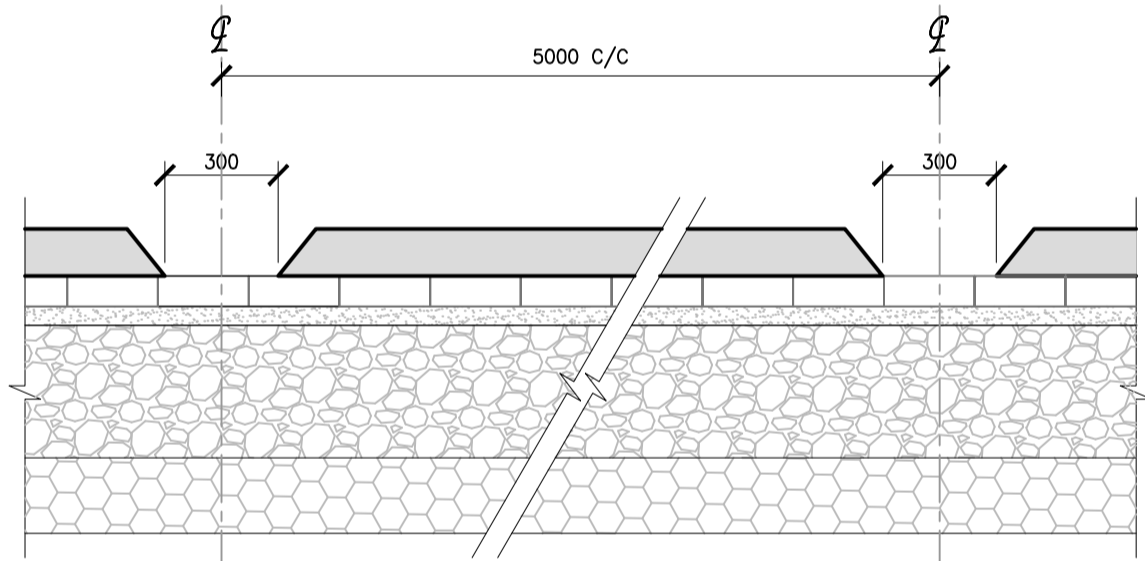

TYPICAL ELEVATION

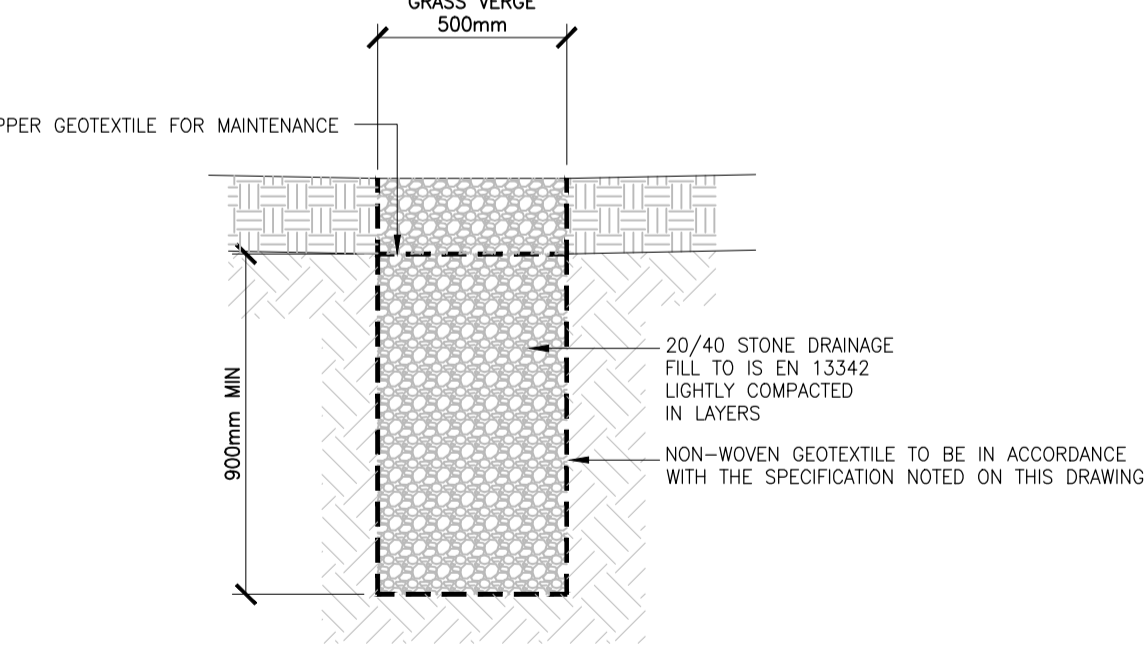

TYPICAL SECTION THROUGH RAINGARDEN/BIORETENTION AREA
 SCALE 1:20



REV	DESCRIPTION	DATE	BY	CHK
7	ATTENUATION POND AMENDED	07.02.24	KA	PB
6	ATTENUATION POND AMENDED	04.02.24	KA	PB
5	DETENTION BASIN AMENDED TO POND	01.02.24	KA	PB
4	ISSUED FOR INFORMATION	19.12.23	KA	PB
3	ISSUED FOR INFORMATION	15.12.23	KA	PB
2	ISSUED FOR INFORMATION	14.12.23	JC	PB
1	ISSUED FOR INFORMATION	05.12.23	JC	PB
0	ISSUED FOR PLANNING	22.11.23	KA	PB

STATUS: **P3 - PLANNING**

MDR
 MALONE O'REGAN CONSULTING ENGINEERS

Unit 2B Richview Office Park, Clonskeagh, DUBLIN 14 D14 XT57
 T: +353 1 260 2655
 E: dublin@mor.ie
 W: www.maloneoregan.ie

Offices also in:
 GALWAY T: +353 91 531 069 E: galway@mor.ie
 WATERFORD T: +353 51 876 855 E: waterford@mor.ie

CLIENT: **NDA ON BEHALF OF KILDARE COUNTY COUNCIL**

JOB NAME: **SHB 4&5 - OCK - OLDTOWN MILL, CELBRIDGE**

DRG. NAME: **SITE DEVELOPMENT DETAILS SUDS DRAINAGE DETAILS**

JOB REF	SHEET	SCALE	DATE	BY	ENG	APP	REV
23006	A1	SHOWN	NOV '23	KA	KA	PB	7

DRG. NO.: **SHB5-OCK-DR-MOR-CS-P3-151**