





LEGEND:

Schedule Part I - Lands Being Permanently Acquired.
Land other than land consisting of a house or houses unfit for human habitation and not capable of being rendered fit for human habitation at reasonable expense

Schedule Part II - Lands Being Temporarily Acquired.
Land other than land consisting of a house or houses unfit for human habitation and not capable of being rendered fit for human habitation at reasonable expense (until the completion of the road development, unless stated otherwise, to which the scheme relates)

Schedule Part III - Part A
Public Rights Of Way To Be Extinguished

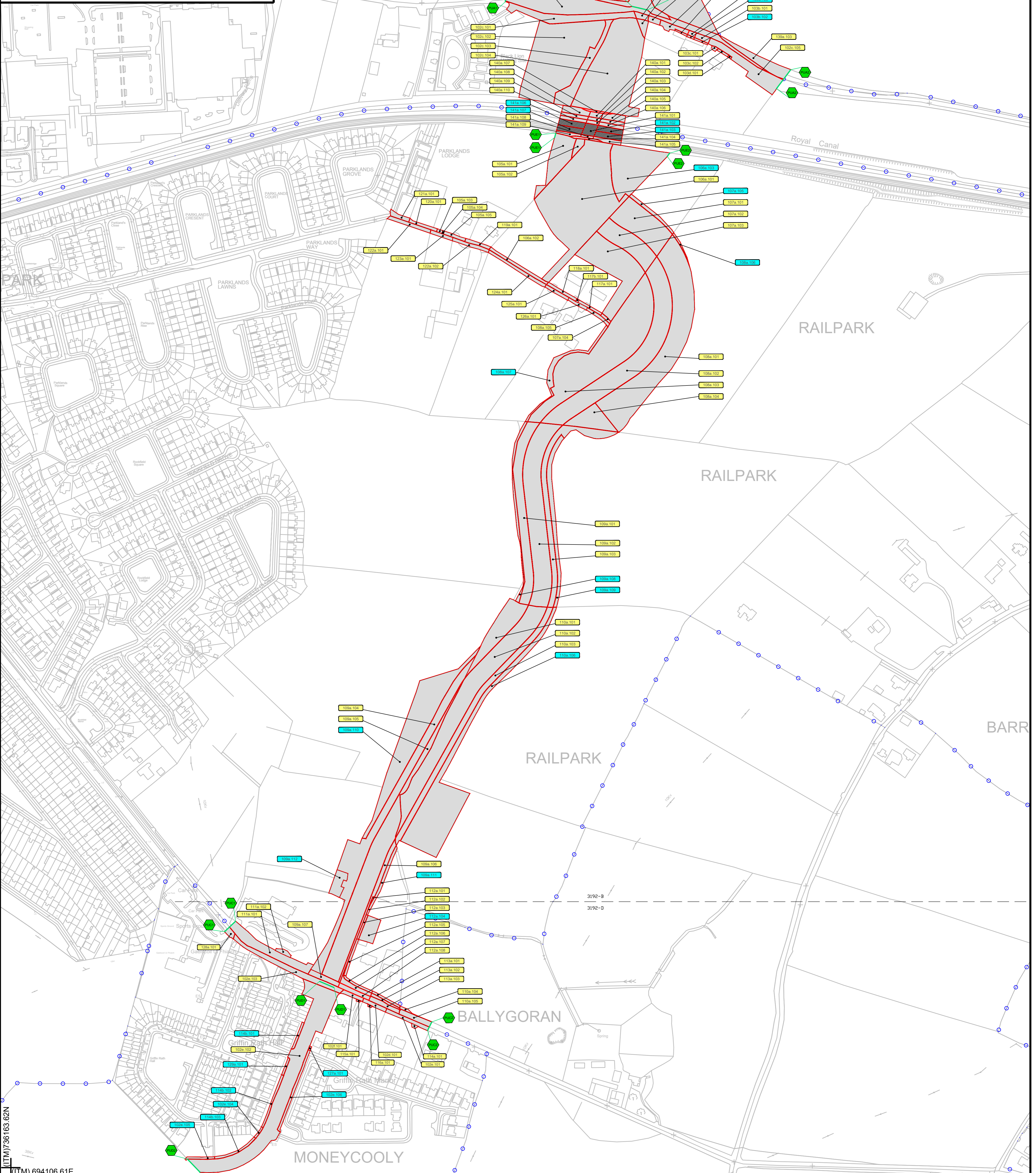
Townland Boundary

KILDARE COUNTY COUNCIL
Comhairle Contae Chill Dara.
Aras Chill Dara, Devoy Park, Naas, Co. Kildare
W91 X77F
T:+353-45-980200

Evelyn Wright
Director of Services,
Roads & Transportation

Stephen Deegan
Senior Engineer,
Roads & Transportation

Index to Ordnance Survey Mapping on this sheet. The Acquisition lines on this drawing have been drawn to Irish Transverse Mercator and are based on Ordnance Survey of Ireland Maps. Licence no. 2015/09/CCMA/Kildare County Council

Prepared by:	EP	Scale:	1:2500 @ A1
Checked by:	IF	Approved by:	KK
Drawing No.:	MERR-ROD-LLO-SW_AE-M2-CH-50000		

KILDARE COUNTY COUNCIL
MAYNOOTH EASTERN RING ROAD
COMPULSORY PURCHASE ORDER, 2022
(as modified by An Bord Pleanála)

Dated the _____ day of _____ 2022
PRESENT when the Seal of KILDARE COUNTY COUNCIL was affixed hereto:-

CHIEF EXECUTIVE _____

COUNTY SECRETARY _____

NOMINATED MEMBER _____

NOMINATED MEMBER _____

DEPOSIT MAP