



-  TREES TO BE RETAINED
-  TREES TO BE REMOVED TO FACILITATE DEVELOPMENT
-  TREES OF VERY LOW QUALITY AND VALUE RECOMMENDED FOR REMOVAL

DRAWING TO BE INTERPRETED WITH REFERENCE TO THE ARBORICULTURAL ASSESSMENT & IMPACT REPORT. TREES TO BE REMOVED #961, #962 & #963 ARE LOW VALUE SPECIMENS (CATEGORY C). TREE #964 IS OF MODERATE VALUE (CATEGORY B). NEW REPLACEMENT PLANTING OF 8 NO TREES WILL IMPROVE THE OVERALL QUALITY OF THE TREE POPULATION WITHIN KILDARE MARKET SQUARE WITH SPECIMENS SUITED TO THEIR LOCATIONS WITH GREATER LONGTERM POTENTIAL THAN THOSE TO BE REMOVED (REFER TO THE LANDSCAPE MASTEPLAN FOR DETAILS ON NEW TREE PLANTING).

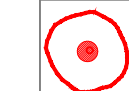
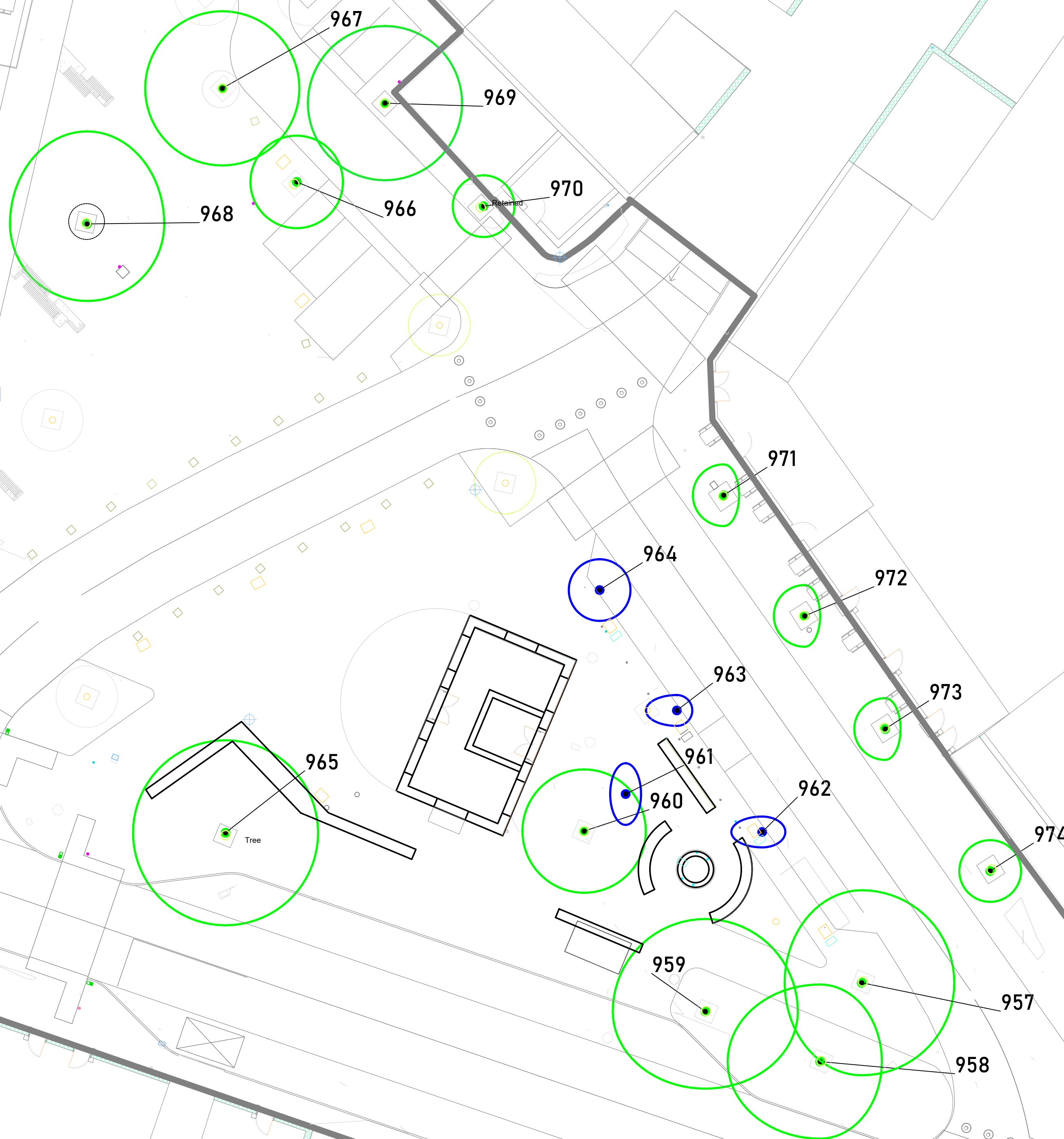

REV	DATE	DESCRIPTION
<b>PROJECT:</b> KILDARE MARKET SQUARE PUBLIC REALM		<b>JOB NO.:</b> TKIL006
<b>DRAWING:</b> ARBORICULTURAL IMPACT		<b>SCALE:</b> 1/200 @ A1
<b>DRAWN BY:</b> CIARAN KEATING	<b>DATE:</b> 18-12-23	<b>CMK</b>
<b>STATUS:</b> PLANNING		<b>INITIALS</b>
<b>DRAWING NO:</b> 102		

NOTES  
Do Not Scale - Use Figure Dimensions Only  
Not for Construction Purposes unless Specifically Noted  
© THIS DRAWING IS COPYRIGHT OF CMK HORTICULTURE & ARBORICULTURE LTD.

