

ISO A1 594mm x 841mm
 Approved: RL
 Checked: KC
 Designer: ES
 Project Management Initials:
 File name: I:\AECOM\NET\COM\FSE\EMEA\DU\BL\IN\EBDL\1\DCS\PROJECTS\BP\60669624_KILDARE_COUNTY_LIBRARY\900_CAD_GIS\906_LA01_SHEETS\60669624-ACM-XX-00-DR-LA-00-1000.DWG
 Last saved by: CRAIG SWEENEY Last Plotted: 2023-03-16

LEGEND

SOFTWORKS

- SORBUS AUCUPARIA
- SORBUS ARIA
- BETULA PENDULA
- RETAINED EXISTING TREE
- SCREENING PLANTING
SEE SOFTWORKS SHEET 7001
- SWALE PLANTING
SEE SOFTWORKS SHEET 7001
- ORNAMENTAL PLANTING
WITH HEDERA HELIX ON WALL.
SEE SOFTWORKS SHEET 7001
- SENSORY PLANTING
SEE SOFTWORKS SHEET 7001

HARDWORKS

- NATURAL STONE GRANITE MID GREY
- NATURAL STONE - TYPE A GRANITE LIGHT GREY
- NATURAL STONE - TYPE B GRANITE LIGHT GREY
- RESIN BOUND GRAVEL BUFF
- BRICK PAVING COLOUR - RED MIX, HERRING BONE 215 mm x 102.5 mm x 65 mm
- GRANITE SETTS LIGHT GREY - 100 x 100mm
- GRANITE SETTS COLOUR: DARK GREY - 150 x 150mm
- PRECAST CONCRETE PAVING COLOUR: LIGHT GREY 200 x 100 x 100mm
- PRECAST CONCRETE PAVING COLOUR: MID GREY 200 x 100 x 100mm
- ROOF LINE

SITE FURNITURE

- RETAINING SEAT WALL CONCRETE
- BENCH TIMBER BENCH
- CURVED RADIUS BENCH TIMBER BENCH
- SEATING WALL BENCH TIMBER BENCH
- CYCLE HOOPS SEE DETAILS
- INFILL TREE GRILLE 1500 x 1500
- DEMARICATION STUDS STAINLESS STEEL TO COURTYARD PARKING SPACES
- CAR PARKING SPACES

RAILING

- 1.2m HIGH GALVANISED STEEL
- HAND RAILING 1.2m HIGH
- CYCLE AND BIN SHELTER TO ARCHITECTS
- LIGHT POLE REFER TO LIGHTING LAYOUT
- UNDER SEAT LIGHTING SEAT WALL
- UNDER SEAT LIGHTING BENCH
- STEPS LIGHTING TO OTHERS

EXISTING GRAVEL BUFF

- PCC KERB 125 x 150 x 914mm
- PIN KERB 50 x 150 x 914mm PCC
- DROP KERB 125 x 150 x 914mm
- GALVANISED STEEL EDGE
- TACTILE PAVING 400 x 400 x 80mm, PCC BLISTER AND CORDUROY PAVING
- ASPHALT ROAD SURFACE TO OTHERS
- CYCLE SURFACE
- RETAINING WALL CONCRETE
- SLOT DRAIN SEE CIVIL LAYOUT FOR DETAILS

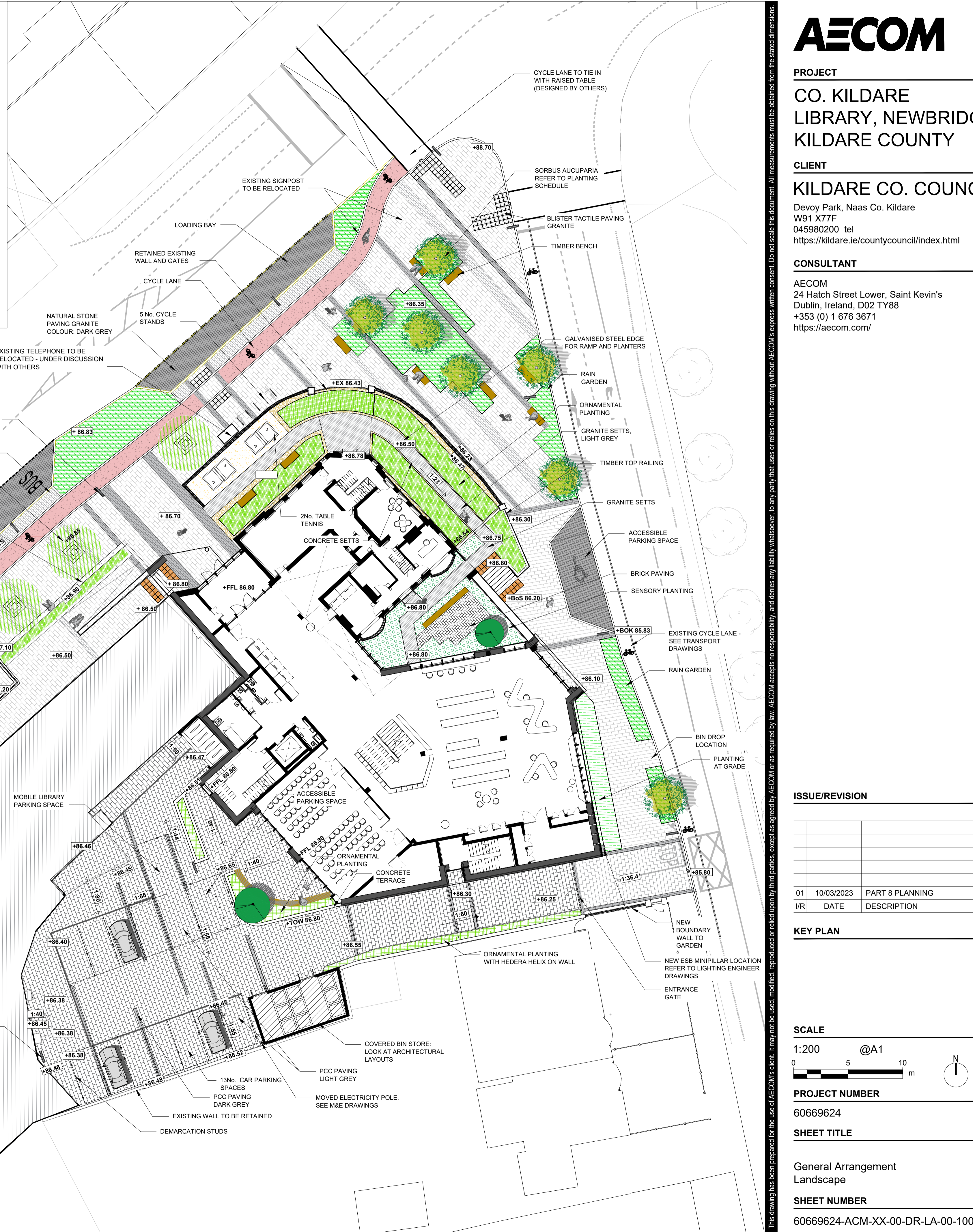

AECOM

PROJECT

CO. KILDARE
 LIBRARY, NEWBRIDGE
 KILDARE COUNTY

CLIENT

KILDARE CO. COUNCIL
 Devoy Park, Naas Co. Kildare
 W91 X77F
 045980200 tel
 https://kildare.ie/countycouncil/index.html

CONSULTANT

AECOM
 24 Hatch Street Lower, Saint Kevin's
 Dublin, Ireland, D02 TY88
 +353 (0) 1 676 3671
 https://aecom.com/

ISSUE/REVISION

NO	DATE	DESCRIPTION
01	10/03/2023	PART 8 PLANNING
I/R		

KEY PLAN

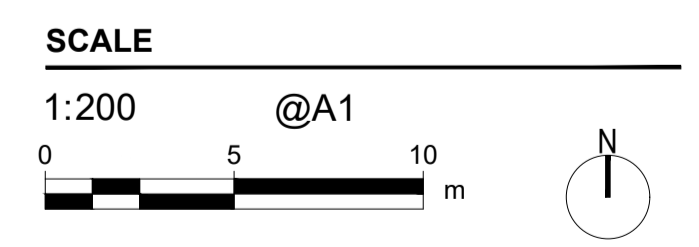

PROJECT NUMBER

60669624

SHEET TITLE

General Arrangement
 Landscape

SHEET NUMBER

60669624-ACM-XX-00-DR-LA-00-1000

This drawing has been prepared for the use of AECOM's client. It may not be used, modified, reproduced or relied upon by third parties, except as agreed by AECOM or as required by law. AECOM accepts no responsibility, and denies any liability, whatsoever, to any party that uses or relies on this drawing without AECOM's express, written consent. All measurements must be obtained from the stated dimensions.