

TYPICAL SECTION THROUGH PRIVATE ACCESS
SECTION (A-A)
SCALE 1:50

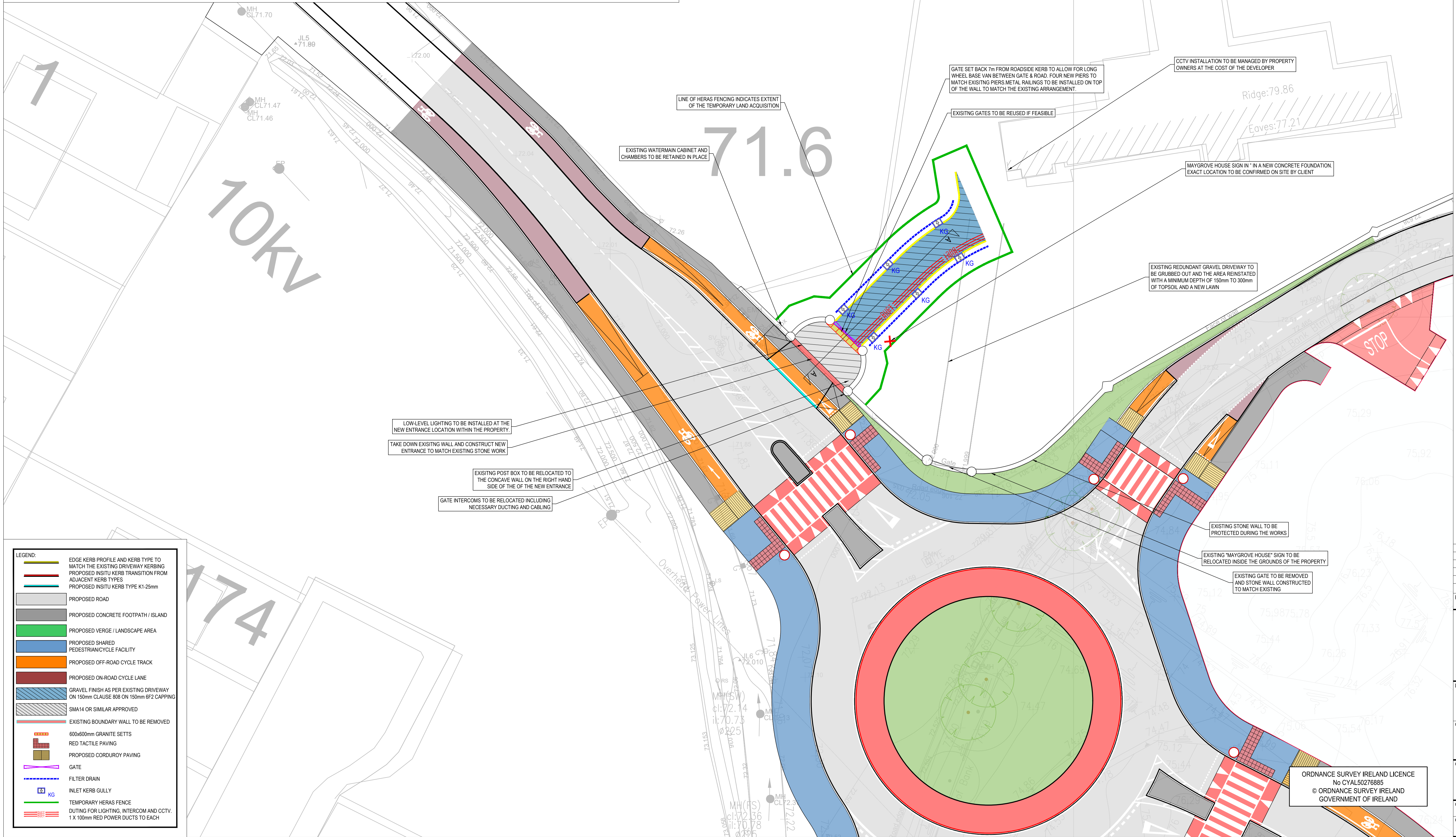

- LEGEND:
- EDGE KERB PROFILE AND KERB TYPE TO MATCH THE EXISTING DRIVEWAY KERBING
 - PROPOSED INSITU KERB TRANSITION FROM ADJACENT KERB TYPES
 - PROPOSED INSITU KERB TYPE K1-25mm
 - PROPOSED ROAD
 - PROPOSED CONCRETE FOOTPATH / ISLAND
 - PROPOSED VERGE / LANDSCAPE AREA
 - PROPOSED SHARED PEDESTRIAN/CYCLE FACILITY
 - PROPOSED OFF-ROAD CYCLE TRACK
 - PROPOSED ON-ROAD CYCLE LANE
 - GRAVEL FINISH AS PER EXISTING DRIVEWAY ON 150mm CLAUSE 808 ON 150mm 6F2 CAPPING
 - SMA14 OR SIMILAR APPROVED
 - EXISTING BOUNDARY WALL TO BE REMOVED
 - 600x600mm GRANITE SETTS
 - RED TACTILE PAVING
 - PROPOSED CORDUROY PAVING
 - GATE
 - FILTER DRAIN
 - INLET KERB GULLY
 - TEMPORARY HERAS FENCE
 - DUCTING FOR LIGHTING, INTERCOM AND CCTV, 1 X 100mm RED POWER DUCTS TO EACH

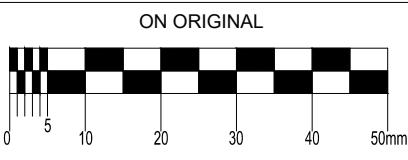
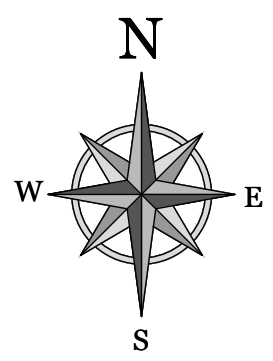

© COPYRIGHT OF THIS DRAWING IS RESERVED BY DBFL CONSULTING ENGINEERS. NO PART SHALL BE REPRODUCED OR TRANSMITTED WITHOUT THEIR WRITTEN PERMISSION.

NO CHANGES OF WHATSOEVER NATURE ARE TO BE MADE TO ANY DETAILS SET OUT OR CONTAINED IN ANY DBFL SPECIFICATIONS OR DRAWINGS UNLESS THE EXPRESS CONSENT HAS BEEN OBTAINED IN ADVANCE, IN WRITING, FROM DBFL.

NOTES:

GENERAL NOTES:

- ALL WORKS SHALL BE CONSTRUCTED IN ACCORDANCE WITH THE WORKS REQUIREMENTS.
- ALL DIMENSIONS IN METRES UNLESS SPECIFIED OTHERWISE.
- ALL CO-ORDINATES ARE TO IRISH TRANSVERSE MERCATOR GRID.
- ALL LEVELS ARE TO ORDNANCE DATUM (MALIN HEAD).
- ALL TEMPORARY TRAFFIC MANAGEMENT SHALL COMPLY FULLY WITH THE WORKS REQUIREMENTS - REFER TO APP 1/17.
- THE CONTRACTOR MUST LIAISE DIRECTLY WITH KILDARE COUNTY COUNCIL DEPARTMENTS AS DIRECTED IN THE WORKS REQUIREMENTS.
- ALL VEHICULAR, PEDESTRIAN & CYCLE ROUTES WITHIN AND SURROUNDING THE WORKS EXTENTS MUST BE MAINTAINED THROUGHOUT THE WORKS IN ACCORDANCE WITH THE CONTRACTORS APPROVED TEMPORARY TRAFFIC & OPERATIONS MANAGEMENT PLAN.
- ALL PERMANENT TRAFFIC MANAGEMENT TO BE CONCEALED/REMOVED OR INCORPORATED INTO THE CONTRACTORS TEMPORARY TRAFFIC MANAGEMENT PLAN THROUGHOUT WORKS AND TRANSFERRED ONLY WHEN AGREED WITH KCC TRAFFIC DEPARTMENT.
- THE CONTRACTOR IS RESPONSIBLE FOR THE ONGOING MAINTENANCE OF TRAFFIC SIGNALS FROM THE STARTING DATE TO SUBSTANTIAL COMPLETION. THIS INCLUDES ALL TEMPORARY TRAFFIC SIGNALS WHILE IN TRANSITION BETWEEN THE CURRENT TRAFFIC MANAGEMENT REGIME AND THE PROPOSED TRAFFIC MANAGEMENT REGIME.
- ALL AGGREGATES PROPOSED FOR USE ON THIS SCHEME SHALL MEET FULLY THE REQUIREMENTS OF THE CONTRACT SPECIFICATION AND IN ADDITION THE REQUIREMENTS STATED IN STANDARD RECOMMENDATION S.R. 21:2014 GUIDANCE ON THE USE OF L.S. EN 12620:2002 +A1:2007 - AGGREGATES FOR UNBOUND AND HYDRAULICALLY BOUND MATERIALS FOR USE IN CIVIL ENGINEERING WORK AND ROAD CONSTRUCTION. FURTHER DETAIL IS PROVIDED IN ADDITIONAL CLAUSE 1444R OF THE CONTRACT SPECIFICATION.

DRAWING SPECIFIC NOTES:

- FOR FURTHER DETAIL AND DIRECTION ON THE WORKS THE CONTRACTOR SHALL REFER AS FOLLOWS:
 - FOR SITE CLEARANCE DRG SERIES 200
 - FOR DRAINAGE, WATER SERVICES & UTILITIES DRG SERIES 500/510/520
 - FOR PAVEMENT/FOOTWAY/CYCLEWAY/SURFACE DRG SERIES 700/710/720
 - FOR TRAFFIC SIGNS/SIGNALS/MARKINGS DRG SERIES 1200/1210
 - FOR PROJECT SPECIFIC CONSTRUCTION DETAILS DRG SERIES 4100
 - FOR PUBLIC LIGHTING DETAILS REFER TO S&RE ELECTRICAL DRAWINGS.
- THE ABOVE DRAWING INFORMATION SHOULD BE READ IN CONJUNCTION WITH THE CONTRACT SPECIFICATION AND ALL REMAINING PARTS OF THE WORKS REQUIREMENTS.



C04	16-12-24	For Agreement	PV	COL
C03	10/10/24	FOR AGREEMENT	PV	COL
C02	26/11/24	CONSTRUCTION	PV	COL
C01	18/10/24	ISSUED FOR COMPLIANCE	PJC	NCG
rev	date	description	by	chkd.

STATUS CODES

purpose	acceptance
P1 - INFORMATION	S - ISSUED

DBFL
CONSULTING ENGINEERS

T: + 353 1 400 4000 | E: info@dbfl.ie | W: www.dbfl.ie
DUBLIN | CORK | GALWAY | WATERFORD

project ref:
CAPDOO LINK ROAD, CLANE, CO
KILDARE

drawing title:
AMENDED ACCESS AT R407

client:
DUNFORM PROPERTIES LIMITED

designed by	author	scale	sheet size
PJC	PJC	1:200	A1
drawing no.	revision		
220092-0100-X-Z00-DTM-SK-DBFL-CE-1250	C04		

ORDNANCE SURVEY IRELAND LICENCE
No CYAL50276885
© ORDNANCE SURVEY IRELAND
GOVERNMENT OF IRELAND