

**GENERAL NOTES**

DO NOT SCALE FROM DRAWINGS. WORK TO FIGURED DIMENSIONS ONLY. ARCHITECT TO BE NOTIFIED OF ANY DISCREPANCIES.

THIS DRAWING TO BE READ IN CONJUNCTION WITH ALL ARCHITECT'S DRAWINGS, SPECIFICATIONS CONSULTANT'S DESIGN TEAM DRAWINGS AND SPECIFICATIONS.



Typical Curtilage Detail - Refer to Key Plan

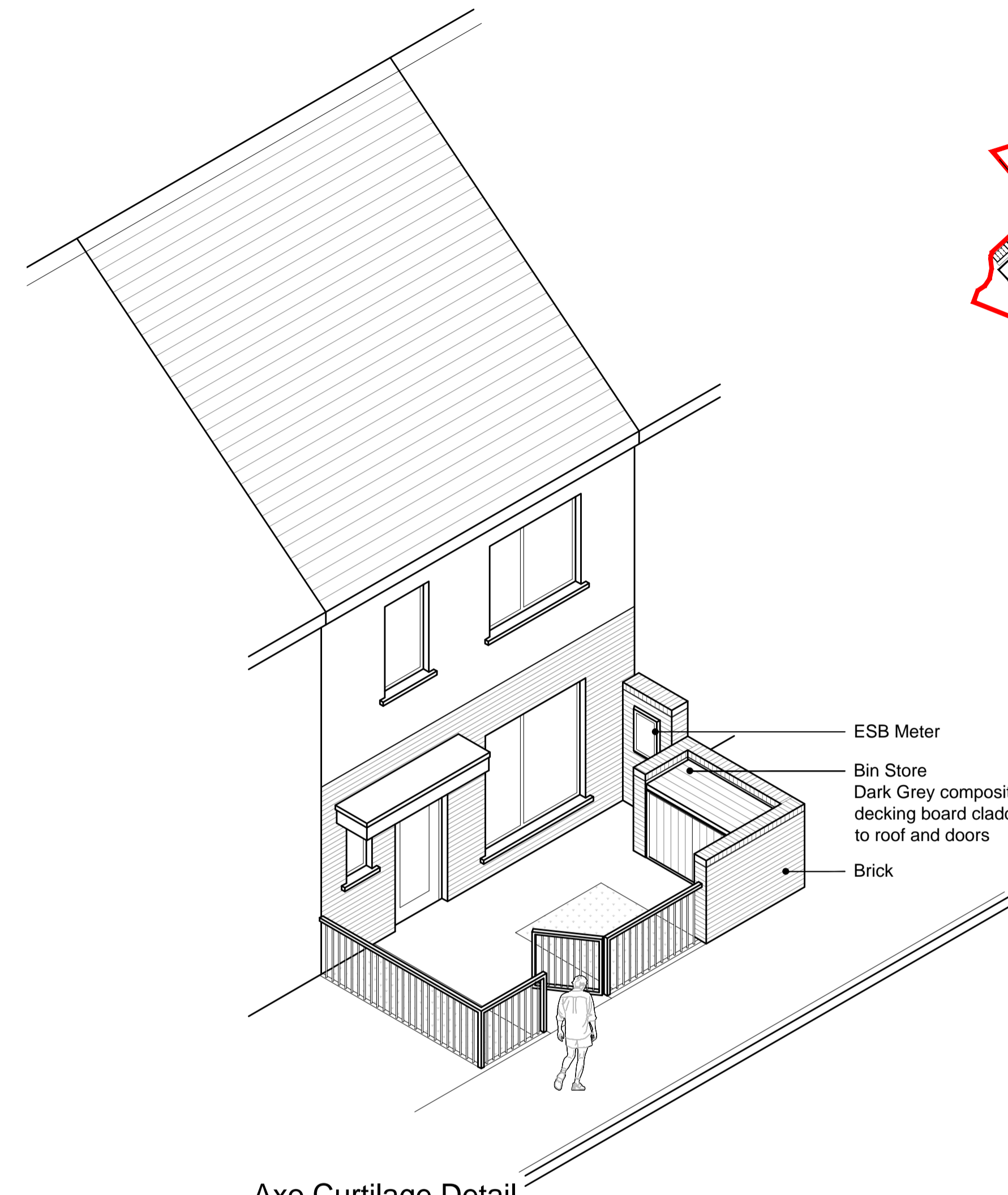

Axo Curtilage Detail

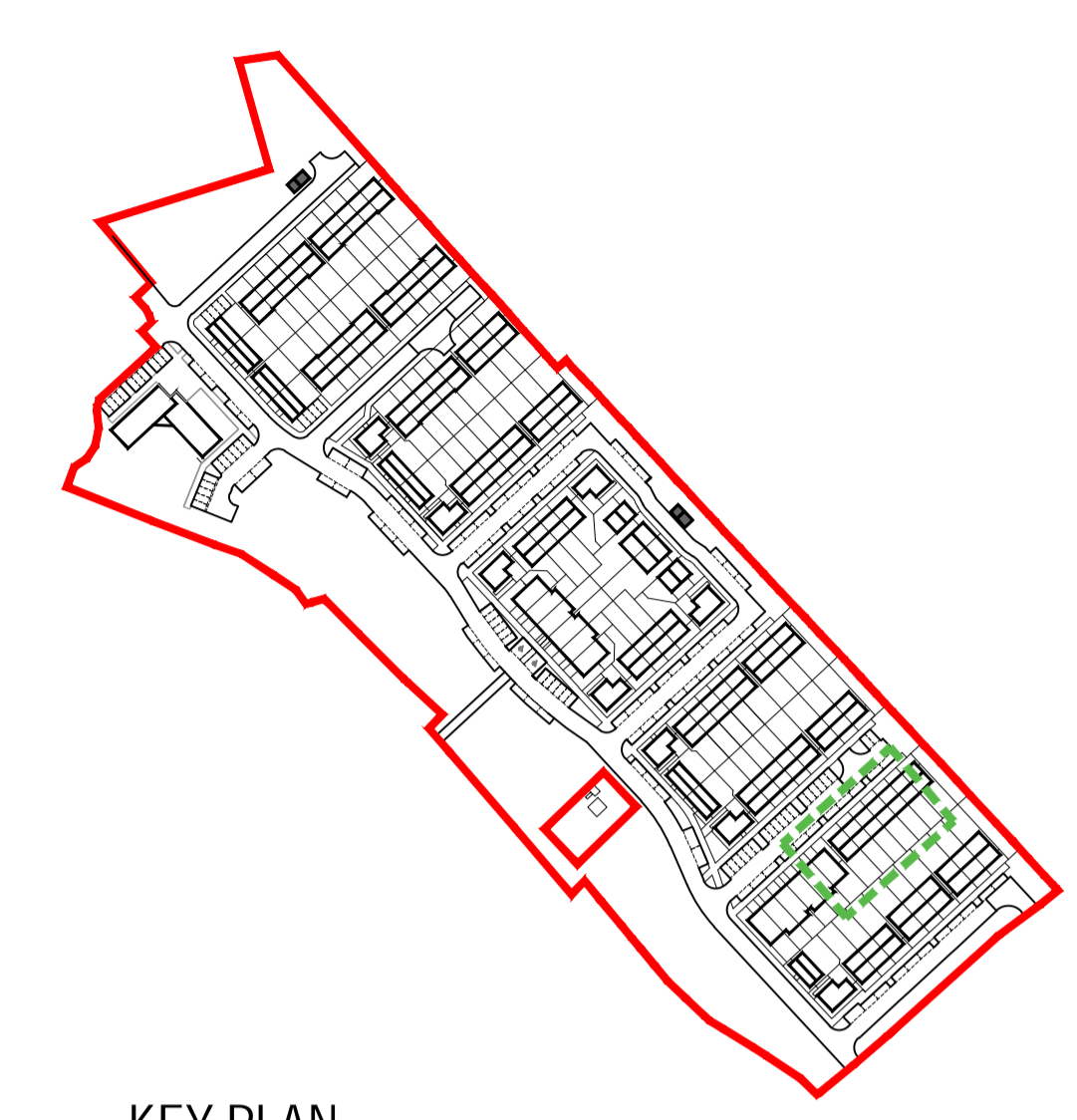

KEY PLAN



Image of typical curtilage treatment to 2-bed, House Type A



Image of typical curtilage treatment to 2-bed, House Type A

REV	DATE	DESCRIPTION	ISSUED BY
REVISIONS			

**FOR PLANNING**

CLIENT:  
 NDFA on behalf of Kildare County Council  
 PROJECT TITLE:  
 SHB 4&5 - CGK - Coolaghknock Glebe, Kildare Town  
 DRAWING TITLE:  
 Typical Curtilage Detail Sheet 3

DRN BY:	CHK BY:	SCALE @ A1:	DATE:	REVISION:	JOB NO.:
PD	DL	1:100	08/05/24		23004
DRAWING NUMBER:					STATUS CODE:
SHB5-CGK-DR-MCORM-AR-P3-PL203					P3

**M'CORM**  
 ARCHITECTURE  
 AND URBAN DESIGN

No. 1 Grantham Street, Dublin 8  
 D08 A4P9 Tel: +353 (0)1 478 8700  
 Block 5, Central Business Park  
 Tallamore, County Offaly  
 R35 F4F8 Tel: +353 (0)57 932 3867  
 website: www.mcorm.com  
 email: arch@mcorm.com