



**MASTERPLAN LEGEND**

- CONSTRUCTED WETLANDS INCORPORATING 113 SPECIES MARGINAL AND AQUATIC PLANTING AND NATIVE TREE PLANTING
- TREE PITS - BUDB MEASURE
- MAIN GARDEN - BUDB MEASURE
- BIORETENTION SWALES - BUDB MEASURE
- TARMACADAM PATH - 2.5M WIDE WITH CONCRETE EDGING
- RECYCLED COMPOSITE TIMBER SEAT WITH BACK REST AND ARM RESTS
- NATURAL PLAY SPACE SUITABLE 0-12 YEARS OF AGE COMPRISING GRASSY HUNDOS, BOULDERS, OLD LOGS AND EQUIPMENT TO ENH 1176 ON RAFA STRIPS SURFACING TO EN 1177
- EXISTING SOIL PITS TO BE RELOCATED WITH LARGE ROCKADIT SPACE
- EXISTING TREES TO BE RETAINED AND PROTECTED DURING CONSTRUCTION
- EXISTING HEDGEROW RETAINED AND AUGMENTED WITH ADDITIONAL NATIVE MIXED SPECIES

**Landscape Plan**  
Scale 1:250

**Key to Landscape Treatments**

**Tree Planting**

- TREE PLANTING:** Pinus cembra 'Chaletker', 18-20cm girth, th.
- TREE PLANTING:** Pinus sylvestris, 1.5-1.8m tall, th.
- TREE PLANTING:** Crataegus monogyna 'Soleira', 18-20cm girth, th.
- TREE PLANTING:** Betula pendula, 18-20cm girth, th. (Silver Birch)
- TREE PLANTING:** Betula pubescens, 14-16cm girth, th.
- TREE PLANTING:** Pinus spicata, 14-16cm girth, th.

**Soft Landscape Treatments**

- PROPOSED NATIVE HEDGEROW PLANTING:** 10% Crataegus monogyna, 40-50cm tr. at 200mm centres; 30% Pinus sylvestris, 2L, up to 200mm centres
- PROPOSED NATIVE HEDGEROW PLANTING:** 10% Calluna vulgaris, 40-50cm tr. at 200mm centres; 10% Linum catharticum, 40-50cm tr. at 200mm centres; 10% Prunella vulgaris, 40-50cm tr. at 200mm centres; 10% Salix repens, 40-50cm tr. at 200mm centres; 10% Sambucus nigra, 40-50cm tr. at 200mm centres; 10% Ilex aquifolium, 2L, up to 200mm centres
- PROPOSED WETLAND TREE & SHRUB PLANTING MIX:** On the Dry Shelf: Corylus avellana, 40-50cm tr. at 5m centres; Viburnum opulus, 40-50cm tr. at 5m centres; Prunella spicata, 40-50cm tr. at 5m centres
- PROPOSED WETLAND EMERGENT PLANTING MIX:** Carex flacca (Common sedge); Typha latifolia (Great reed); Phragmites australis (Common reed); Scirpus cespitosus (Flowering rush); Najas spp. (Mosses)
- PROPOSED MARGINAL PLANTING MIX:** Carex flacca (Common sedge); Lythrum salicaria (Purple Loosestrife); Veronica beccabunga (Blue Veronica); Filipendula ulmaria (Meadow Sweet); Mentha aquatica (Water mint); Myosotis scorpioides (Wild Forget-me-not); Stachys palustris (Marsh Thyme); Carex lasiocarpa (Sedges); Carex acutiformis (Sedges); Ranunculus sceleratus (Cuckoo-pint); Ranunculus lingua (Greater Spearwort); Salix herbacea (Dwarf willow)
- PROPOSED POLLINATING PLANTING MIX:** Galium verum (Sweet Galium); Lysimachia nummularia (Creeping Jenny); Lythrum salicaria (Purple Loosestrife); Veronica beccabunga (Blue Veronica); Filipendula ulmaria (Meadow Sweet); Mentha aquatica (Water mint); Myosotis scorpioides (Wild Forget-me-not); Stachys palustris (Marsh Thyme); Carex lasiocarpa (Sedges); Carex acutiformis (Sedges); Ranunculus sceleratus (Cuckoo-pint); Ranunculus lingua (Greater Spearwort); Salix herbacea (Dwarf willow)
- PROPOSED BAIN GARDEN/BIO-RETENTION PLANTING MIX:** Viburnum opulus, 2L, at 600mm centres; Cornus sanguinea, 2L, at 600mm centres; Vinca minor, 2L, at 600mm centres; Malacotheca coccinea, 2L, at 600mm centres; Crocosmia sp., 2L, at 600mm centres; Rudbeckia hirta, 2L, at 600mm centres; Bergenia sp., 2L, at 600mm centres; Hosta sp., 2L, at 600mm centres; Iris sibirica, 2L, at 600mm centres; Juniperus effusus, 2L, at 600mm centres; Carex pensilis, 2L, at 600mm centres
- PROPOSED GRASS AMENITY LAWN MIX:** 20% Perennial Ryegrass; 30% Perennial Ryegrass; 20% Strain Caring Red Fescue; 10% Tallium pratense; 10% Trifolium repens; 10% Brachiaria dist. at 35-50sq/metre
- PROPOSED WETLAND GRASS MIX:** 10% Creeping Bent; 40% Common Fescue; 10% Tussock Bog; 40% Red Fescue

**Hard Landscape Treatments**

- PROPOSED SURFACE TREATMENT 1:** Concrete footpath
- PROPOSED SURFACE TREATMENT 2:** Tarmacadam road
- PROPOSED SURFACE TREATMENT 3:** Permeable Concrete block paving at 80mm depth
- PROPOSED SURFACE TREATMENT 4:** Concrete flag paving at 30mm depth
- PROPOSED SURFACE TREATMENT 5:** Tarmacadam path
- PROPOSED SURFACE TREATMENT 6:** Safe Grass to EN1177

**SITE FURNITURE**

- PROPOSED SEATING:** Recycled composite timber seat with back and arm rest
- PROPOSED FEATURE 1:** Limestone Boulders of various sizes
- PROPOSED FEATURE 2:** Old Tree Logs and stumps

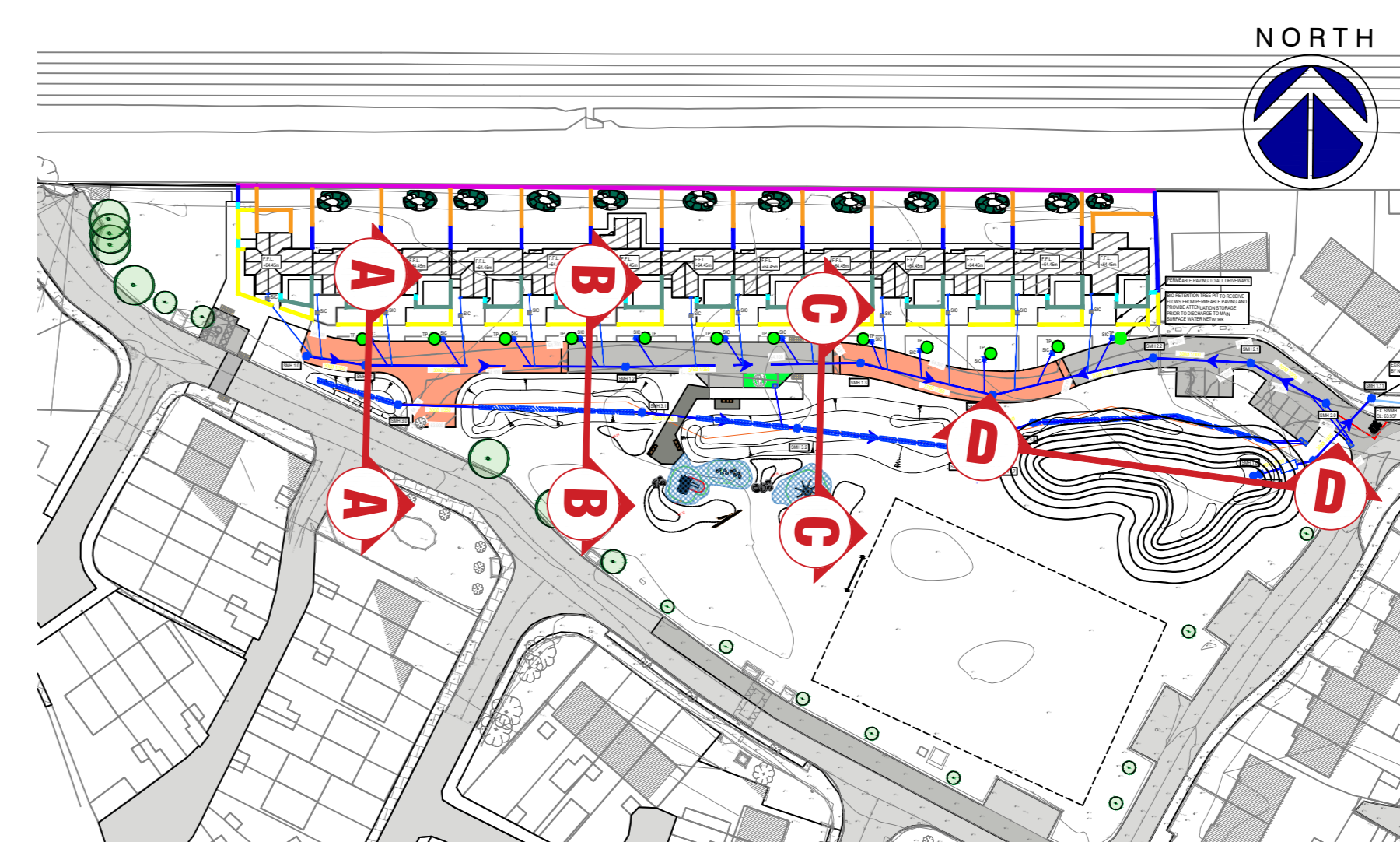

**Key Plan**  
Not to Scale

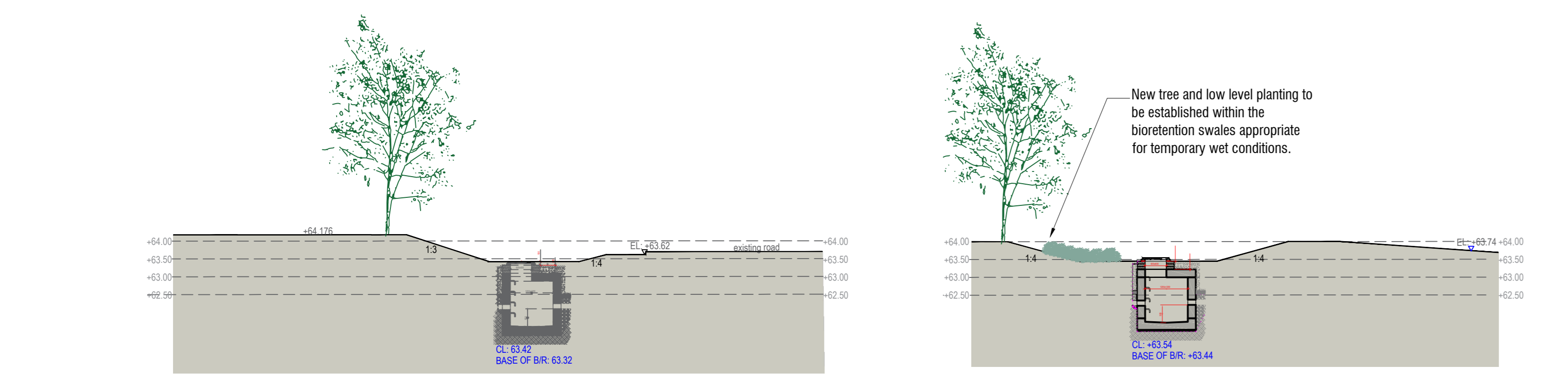

**Section A** Scale 1:100  
**Section B** Scale 1:100

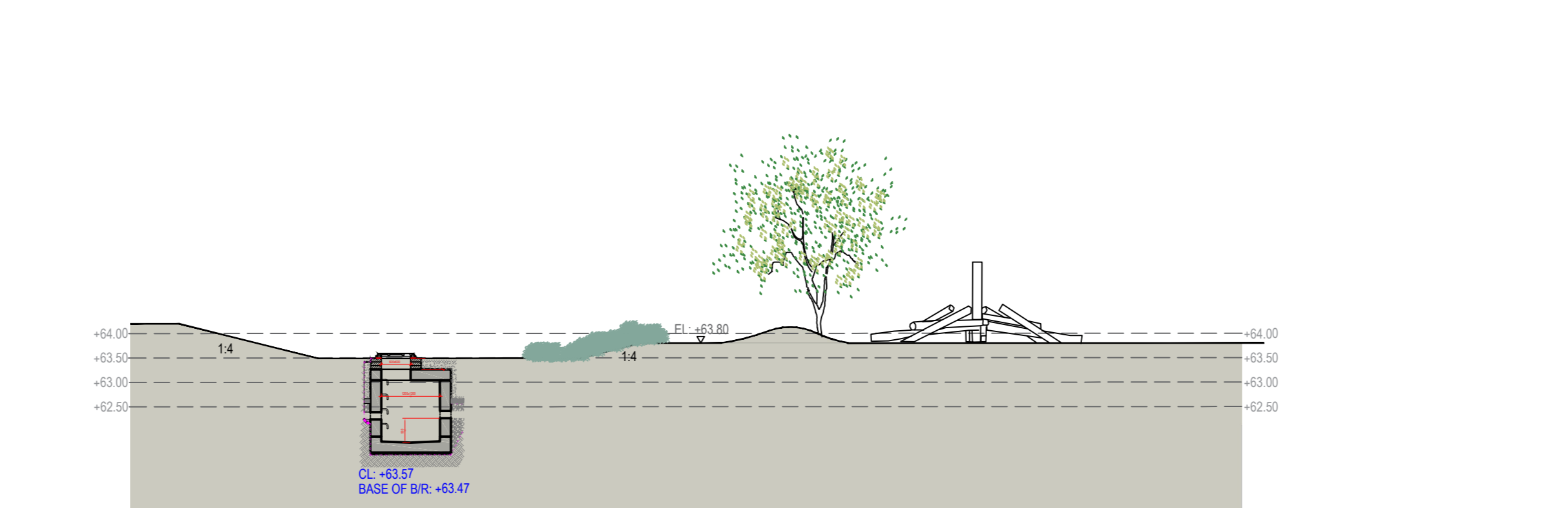

**Section C** Scale 1:100

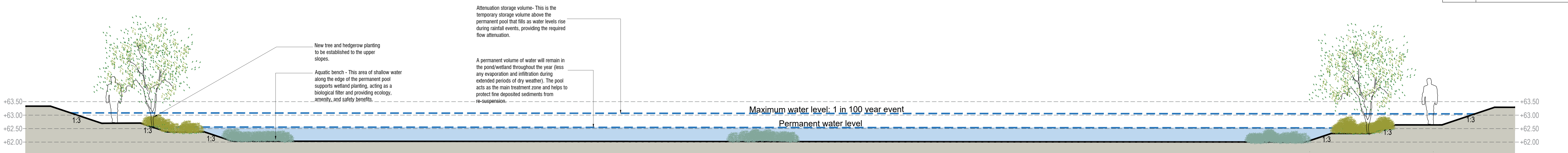

**Section D** Scale 1:50