

TYPICAL LANE SEPARATORS

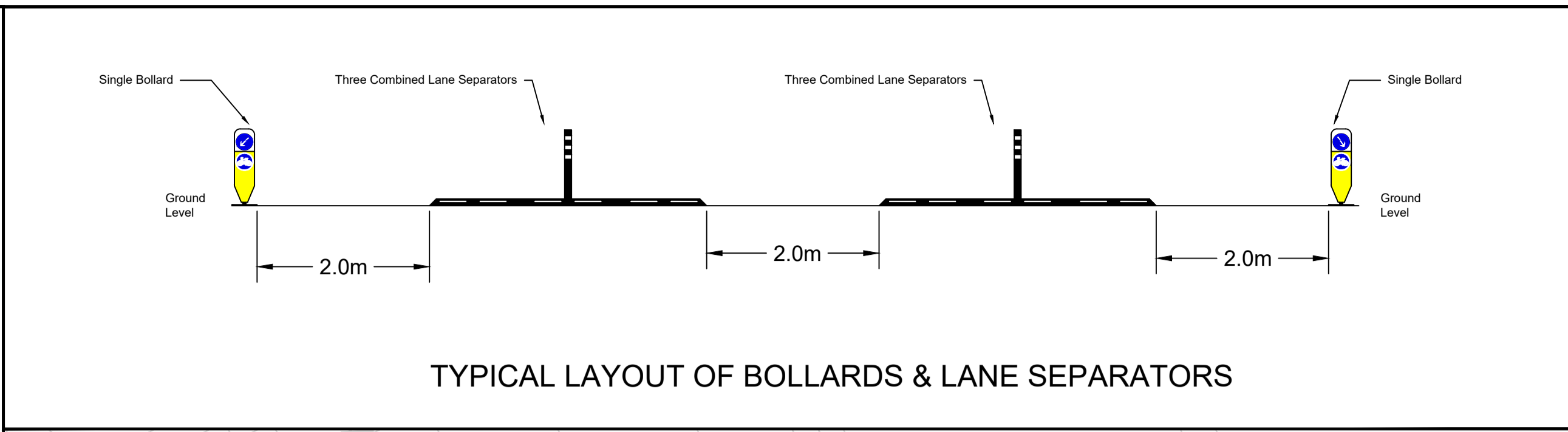

TYPICAL LAYOUT OF BOLLARDS & LANE SEPARATORS

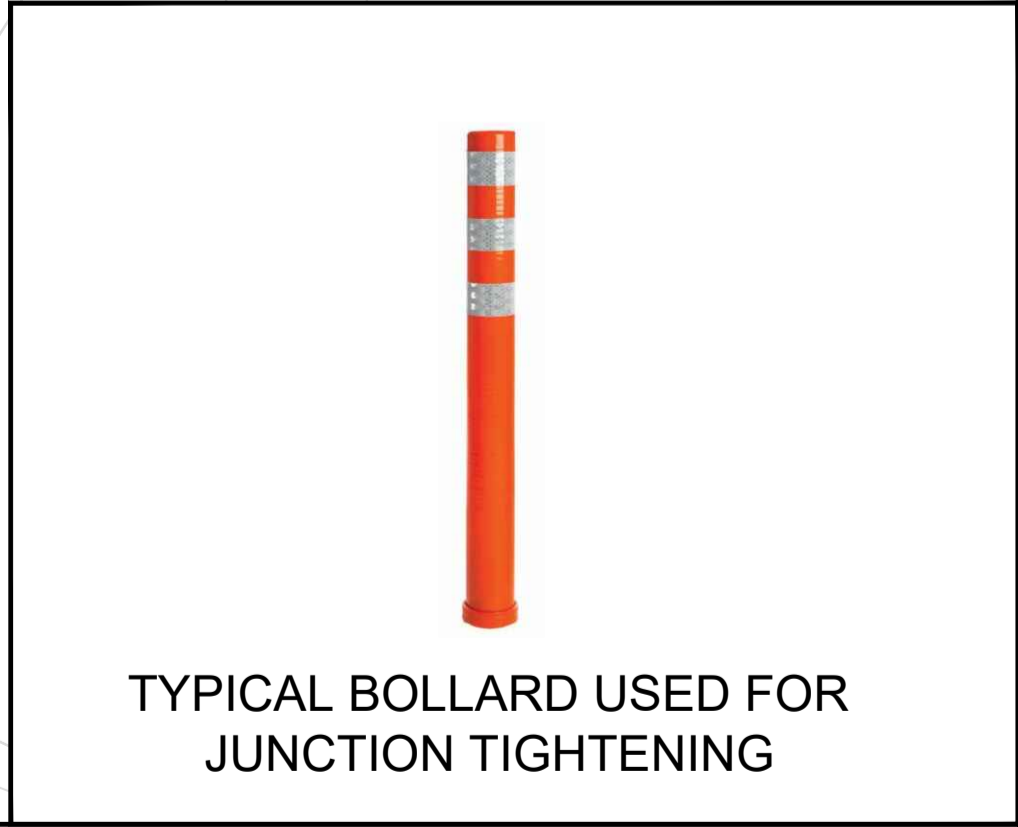
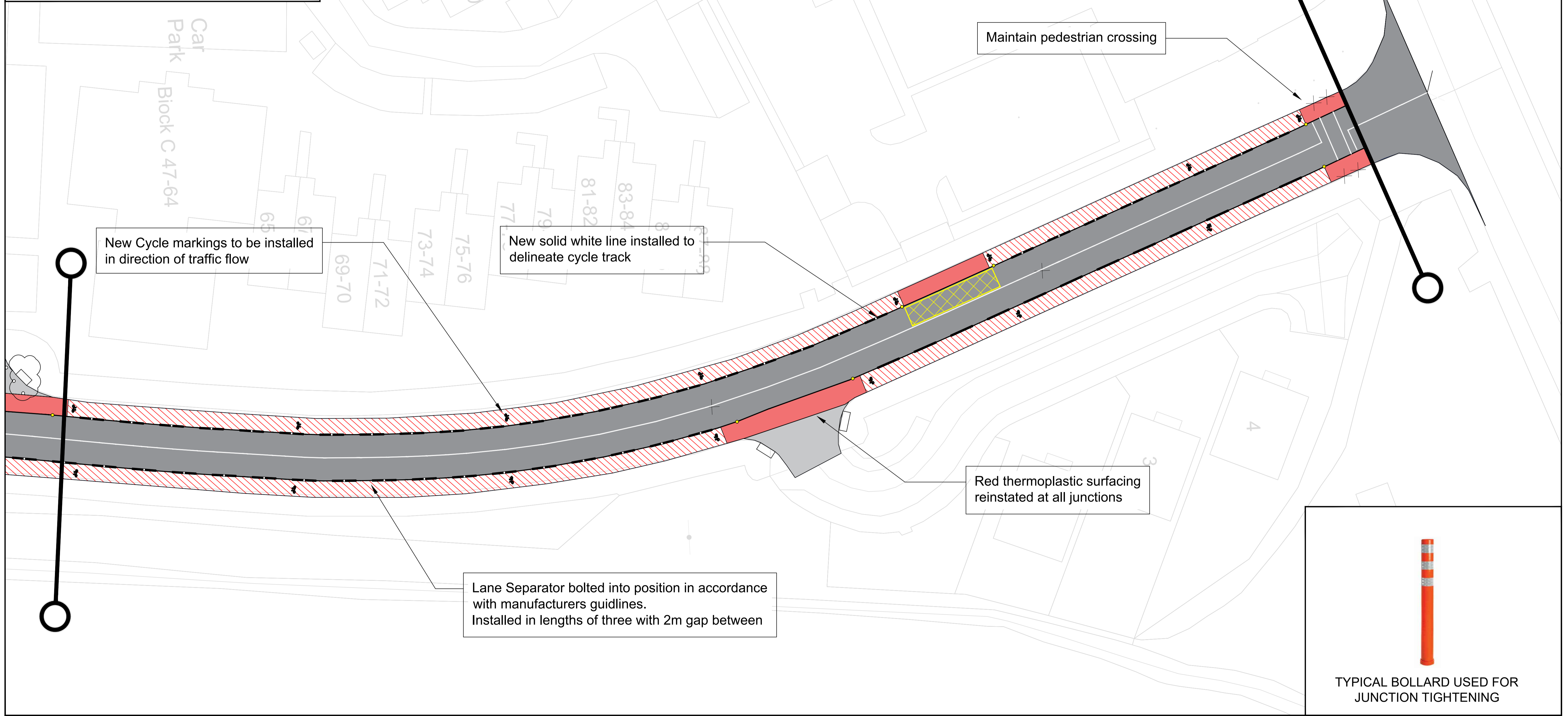

Kildare County Council
Sustainable Transport
Evelyn Wight
Director of Services
Mr. Donal Hodgins BA, BA1, CEng, MEl
Senior Engineer
Roads, Transportation Dept.
Sustainable Transport Section, Áras Chill Dara, Denny Park, Naas, Co. Kildare.
T: +353-45-880424 F: +353-45-880420 E: roads@kildarecoo.ie

Ordnance Survey
© Ordnance Survey (now) License No. 014/2020/17/Kildare County Council

Notes:
DO NOT SCALE, use figured dimensions only.
All sizes to be checked on site and any discrepancies to be reported to the engineer.
All levels are referred to Ordnance Survey Datum, Malin Head.
This document should not be relied on or used in circumstances other than those for which it was originally prepared. Kildare County Council accepts no responsibility for this document to any other party other than the party by whom it was commissioned.

Rev.	Date	Drawn	Description	Chk'd	Appr.
P03					
P02					
P01					

Project Title: Shinkeen Road: Cycle Track Protection Rapid Build Scheme	Status:	<input type="checkbox"/> PRELIM	<input checked="" type="checkbox"/> STATUTORY	<input type="checkbox"/> TENDER	<input type="checkbox"/> CONTRACT
Drawing Title: SHINKEEN RD, CELBRIDGE. PREFERRED OPTION SHEET 03 OF 03	Designed: DMCC	File Name:	Drawing No. 03/03	Rev: P01	
	Drawn: DR	Scale at A1: NTS			
	Checked: PP	Date: 12/03/2024			
	Approved:				

Project Title: Shinkeen Road: Cycle Track Protection Rapid Build Scheme	Status:	<input type="checkbox"/> PRELIM	<input checked="" type="checkbox"/> STATUTORY	<input type="checkbox"/> TENDER	<input type="checkbox"/> CONTRACT
Drawing Title: SHINKEEN RD, CELBRIDGE. PREFERRED OPTION SHEET 03 OF 03	Designed: DMCC	File Name:	Drawing No. 03/03	Rev: P01	
	Drawn: DR	Scale at A1: NTS			
	Checked: PP	Date: 12/03/2024			
	Approved:				

File Name: F:\Users\T\Transportation\Sustainable Transport\STMG Projects\2023\KCC_23_XXXX_Shinkeen Road Celbridge\40 - Phase 3\40.2 Preliminary Design Drawings\Shinkeen Rd_Celbridge - Rev. 3.dwg