

PROPOSED PLAN D1.1
(Scale 1:50)

PROPOSED PLAN D1.2
(Scale 1:50)

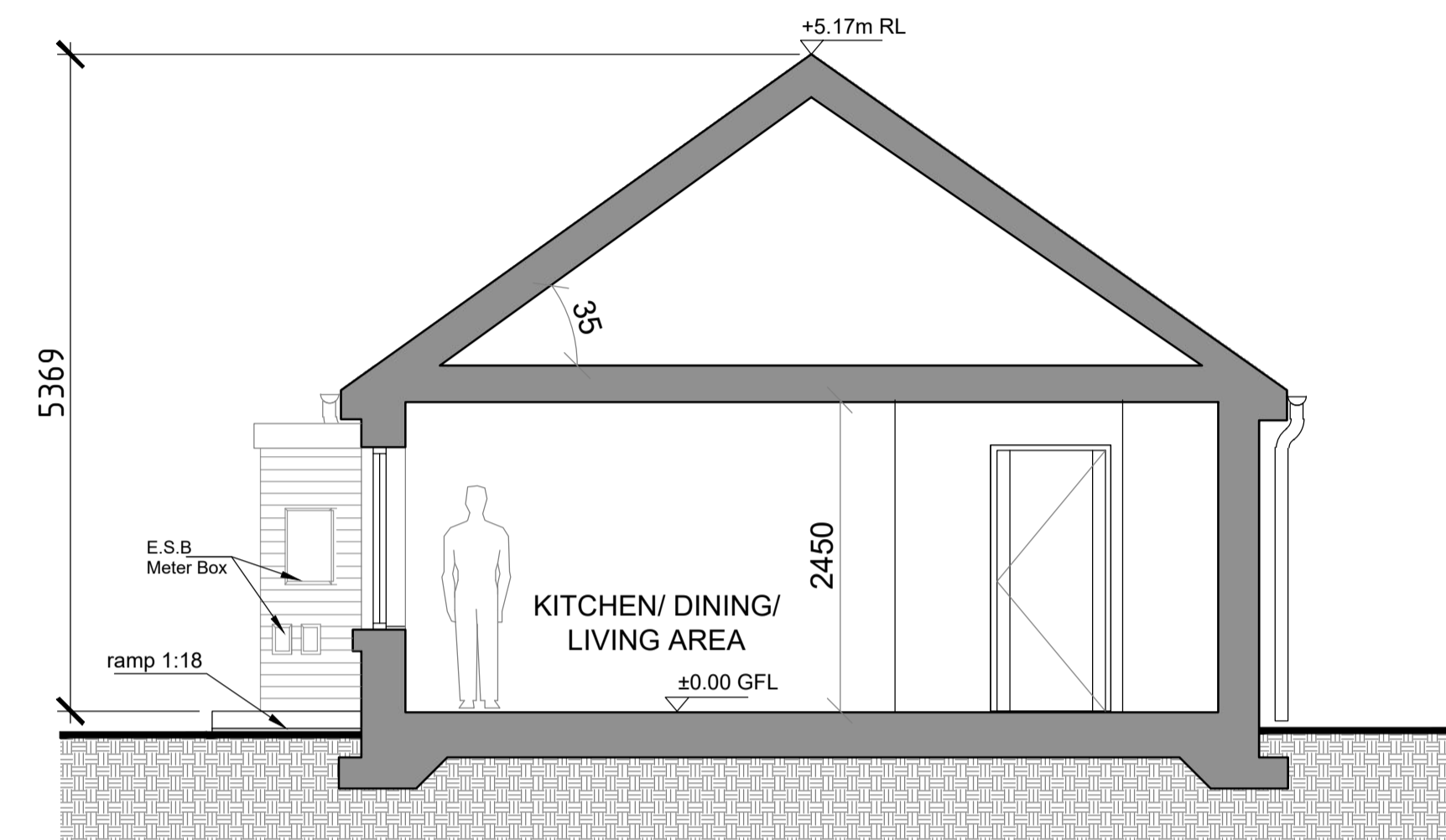

PROPOSED SECTION A-A
(Scale 1:50)

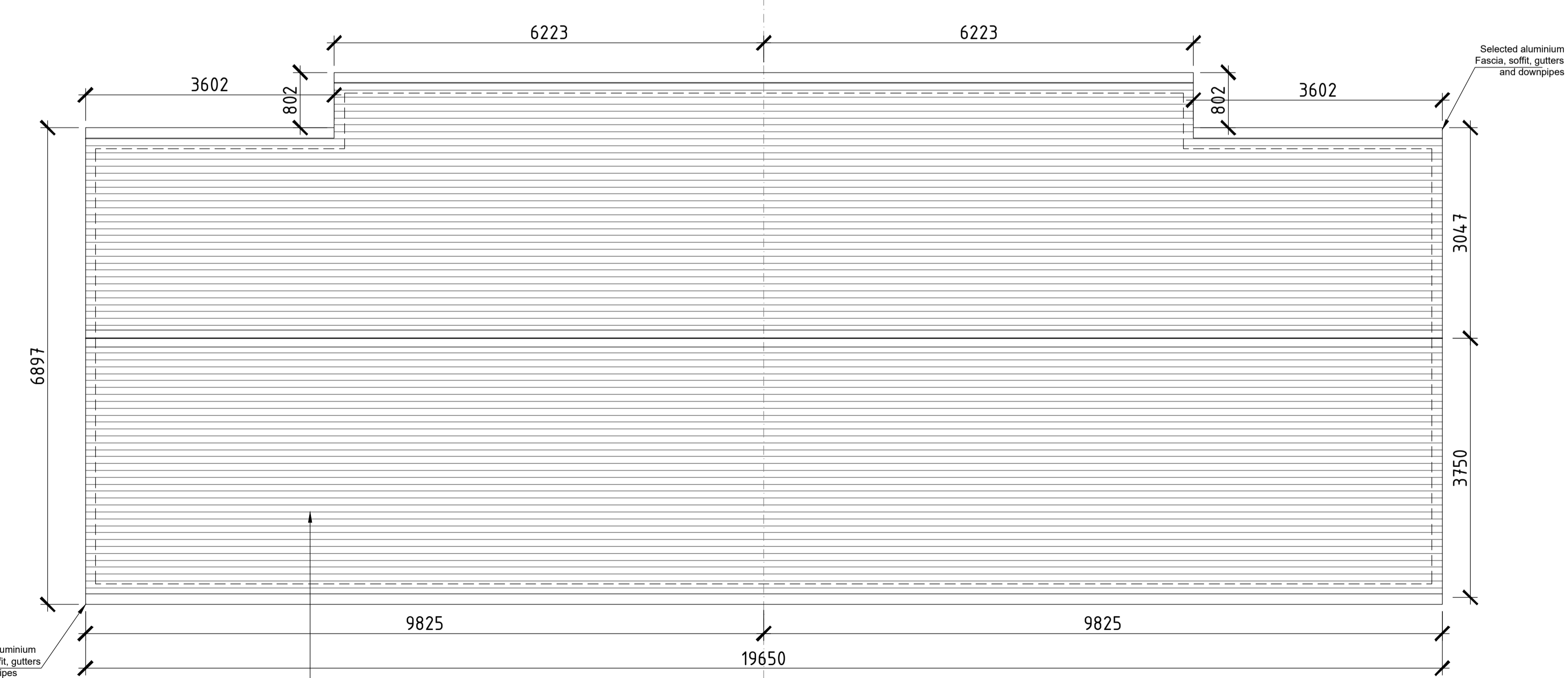

PROPOSED ROOF PLAN D1.1
(Scale 1:50)

PROPOSED ROOF PLAN D1.2
(Scale 1:50)

HOUSE TYPE D1
1 Bed, 2 Person Single Storey

Area:
Ground Floor - 56.1m²
(Storage 3.1m²)

TOTAL - 56.1m² / 603.8ft²

PLANNING

| Rev | Description | By | Date |
|-----|-------------|----|------|
| | | | |

VHA VINCENT HANNON ARCHITECTS
Galway: Suite 4 Cloch Mhile, Suite 4 Abbey Street, Dublin Road, Galway, H91 V97E
Sligo: 1-3 Abbey Street, Abbeyquarter North, Sligo, F91 X160
Maynooth: Office 20, Block B, Maynooth Business Campus, Kildare
E: info@vha.ie T: 091 483 934 F: 071 915 0022 www.vha.ie

Client: Kildare County Council
Project: Proposed Housing Development at Ardclough Road, Celbridge, Co. Kildare
Drawing Description: Proposed House Type D1.1/D1.2 Plan Section
Scale: 1:50 @ A1
Status: Planning
Drawing No: 210303-03-112
Rev: 1
Date: May 2022
Drawn by: TS - WS
Checked by: BF

Refer to Site Plan for exact location and level