

PV panels to be installed to south slope of building. Number and extent to detailed design

LOCATION OF SITE NOTICE

SITE AREA 0.36 Ha. 

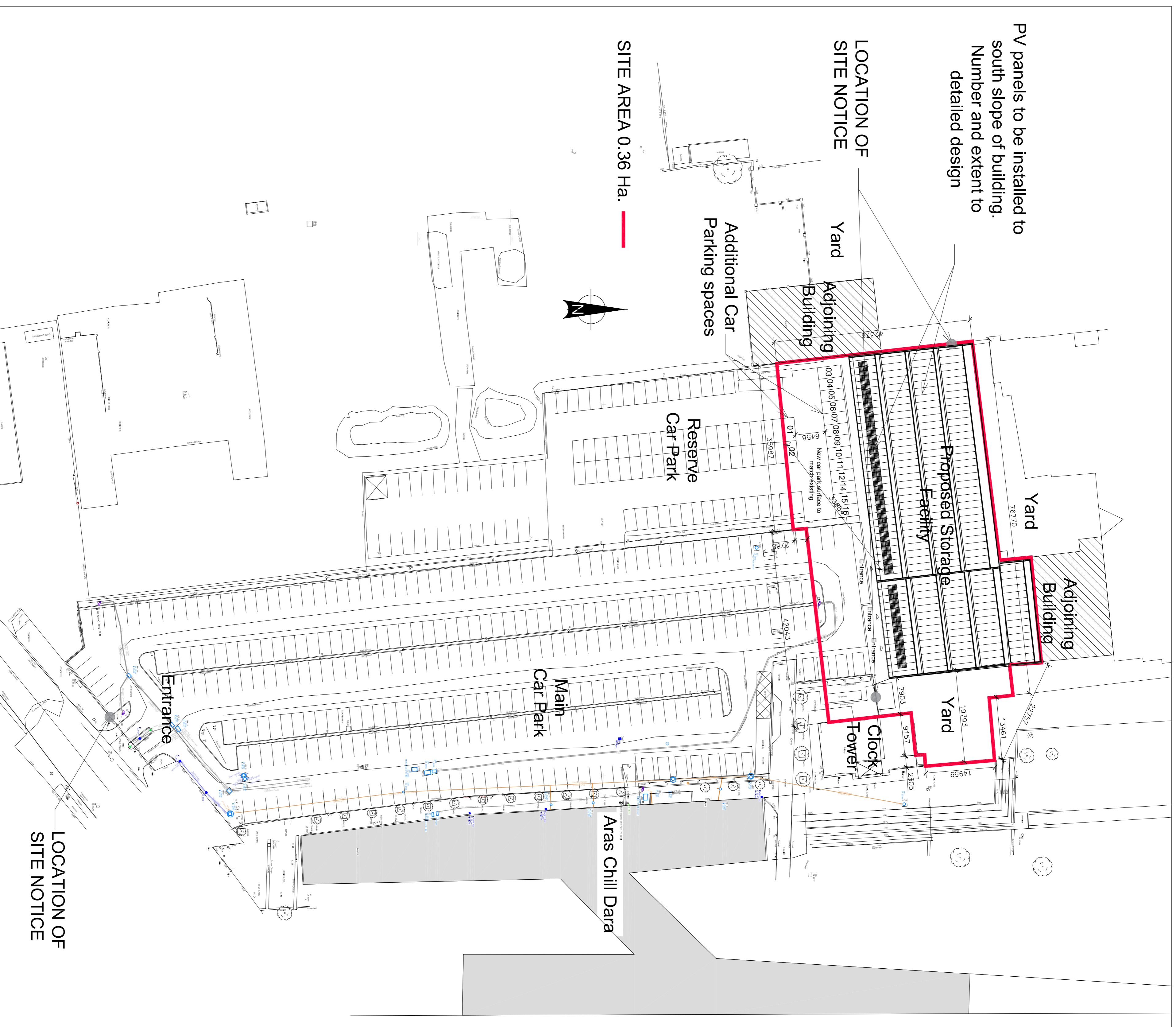

LOCATION OF SITE NOTICE

PROPOSED SITE LAYOUT

SCALE 1:300

PV panels to be installed to south slope of building. Number and extent to detailed design

LOCATION OF SITE NOTICE

SITE AREA 0.36 Ha. 

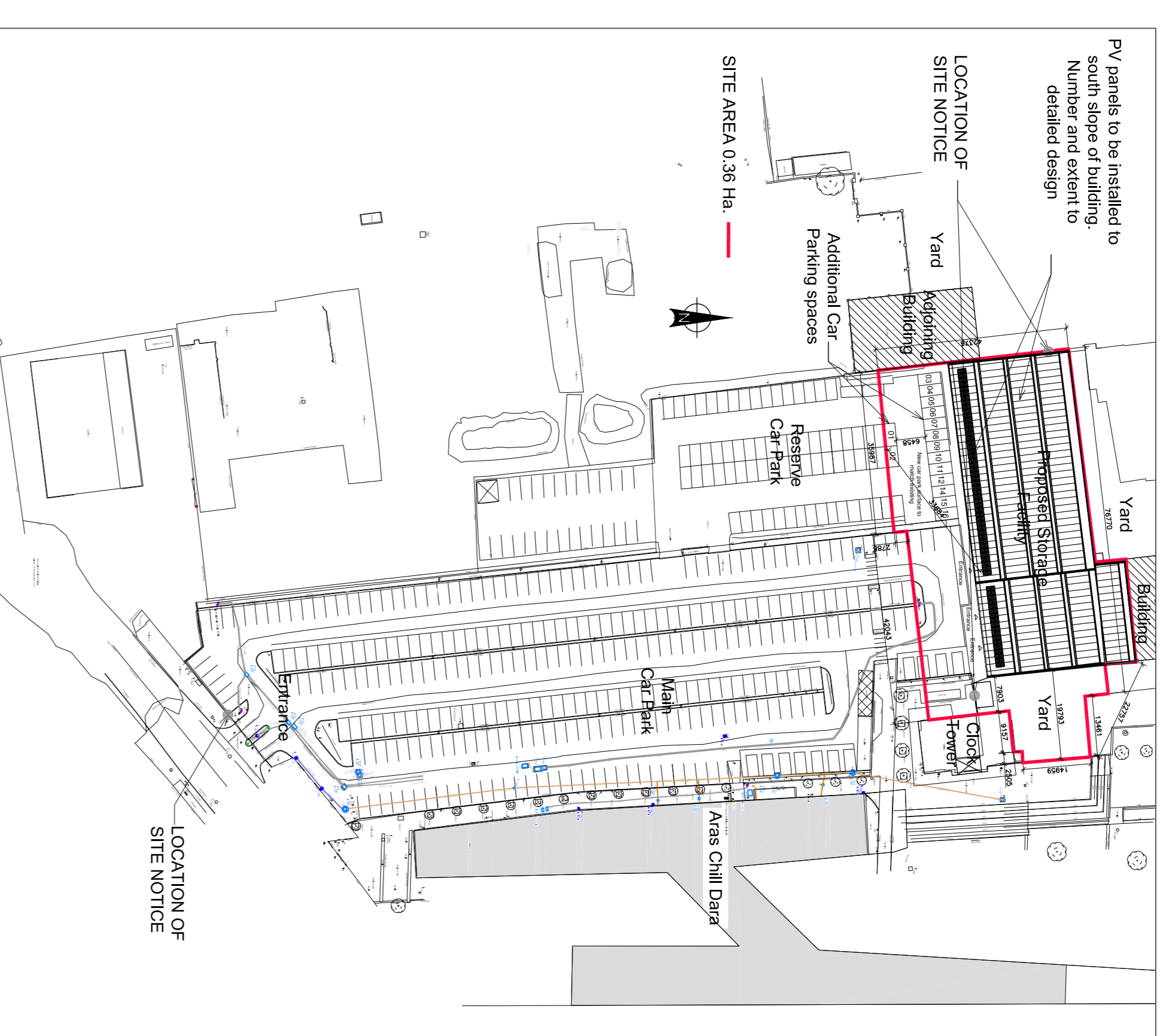

LOCATION OF SITE NOTICE

PROPOSED SITE LAYOUT

SCALE 1:1000

## Part 8 Submission

Ref N. P82021.02

- Notes:**
- This drawing has been prepared for Part 8 purposes only.
  - All drawings to be read in conjunction with all other consultant drawings. Architect to be informed immediately of any discrepancies.
  - Figured dimensions only to be taken from this drawing. All dimensions and levels to be checked on site. Architect to be informed immediately of any discrepancies.

**Revisions:**

Rev#	Notes	Date
01	Part 8 Application	28/03/22
02		
03		
04		
05		

### Kildare County Council,



**Facilities Section,**

Devoey Park,  
Naas,  
Co. Kildare.

**Project:**

Kildare County Council Storage Facility  
Military Road Industrial Park  
Newbridge Road, Naas  
Kildare County Council

**Client:**

Kildare County Council

**Prepared by:**

Facilities Section,  
Kildare County Council.

Facilities Section: Barry Griffin  
Facilities Section: Justin O'Doherty

**DWG:**

Proposed Site Location Map  
1 of 2

Scale: As Shown

Status: Drawn by: JOD  
Part 8

CHK: BG  
Date: 28/03/22

Project No: 2101

Dwg No: 003