

Figure 1 - General Layout Plan
Proposed new Bus Shelters/Boarding platforms

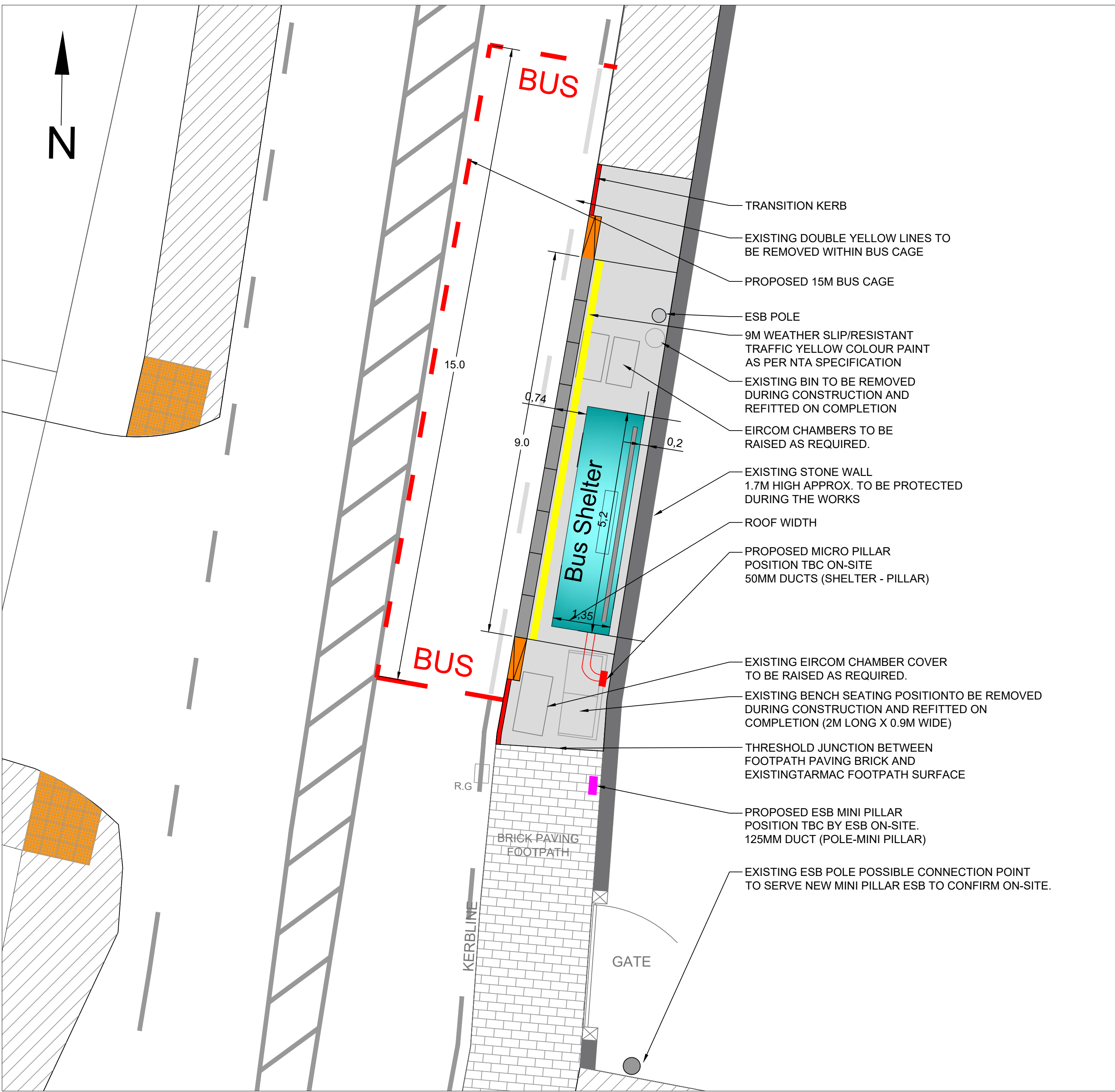

Figure 2 - Detailed Layout Plan
Proposed new Bus Shelters/Boarding platforms



Key Plan - Street Map



Figure 3 - Bus shelter example
'Example of 3 bay Cantilever bus shelter - Exact Shelter to be clarified with Baeur Media Outdoor '

Notes:

- No dimensions to be scaled from this drawing.
- All sizes to be checked on site and any discrepancies to be reported to the engineer.

Legend:

- New footway / hardstanding construction (concrete) ...m²
- Proposed planting
- R.G Existing Gully
- Existing road markings
- ESB Duct (approx. 7m) 63mm diameter ducting
- 9m Accessible kerbing - 160mm high
- Proposed weather/slip resistant paint or resin in a contrasting colour to the hardstanding
- 1m Transition kerbing - 160mm to 125mm (Accessible Kerb)
- Transition Kerb - 6mm upstand to 125mm
- Crossing kerb - 6mm upstand
- Blocks to be painted with a weather/slip resistant paint or resin, in a contrasting colour to the hardstanding.
- Existing bus stop pole.
- Existing lighting column
- Existing sign
- Setting out reference point
- Proposed Bus Stop cage - RPM 030 - 1.0m mark, 1.0m gap, 100mm wide - 1.6m text (20m long cage)
- Remove any existing road markings from within the new cage
- Service cover
- New Mini Pillar. Direction of connection route to nearest ESB Pole or mini-pillar to be agreed with ESB prior to commencement of works onsite.
- Buff Tactile Blister Paving (400 x 400mm)
- Desired gradient 1:20.
- Dropped kerb with max. upstand of 6mm/or flush.
- Reinstate carriageway as result of any new kerb works
- Proposed bus shelter from Bauer Media Outdoor "SUPPLIER, 3 bay Cantilever with narrow roof and no half end panels". Concrete hardstanding area to be casted with a 1:40 surface water fall away.
- Existing continuous road centre line to be refreshed
- New Public Lighting Pole (to assist with uncontrolled Ped. crossing)

Bus Shelter construction.
Please refer to SUPPLIER design details for the shelter structure, including base preparation and structure design

- NOTES:
- ALL DIMENSIONS ARE IN METRES UNLESS OTHERWISE STATED.
 - LOCATIONS ARE APPROXIMATE AND ARE TO BE AGREED ON SITE WITH THE OVERSEEING ORGANISATION.
 - ALL UTILITIES SHOWN ARE INDICATIVE ONLY AND REMAIN THE RESPONSIBILITY OF THE CONTRACTOR.
 - NO TOPOGRAPHIC SURVEY WAS CARRIED OUT PRIOR TO THE DESIGN SHOWN ON THIS DRAWING.
 - SITE CONDITIONS TO BE CHECKED BY THE CONTRACTOR BEFORE PROCEEDING TO ANY TASK.
 - INDICATIVE ROAD MARKINGS HAVE BEEN PREPARED BASED ON AERIAL IMAGERY. ROAD MARKING LAYOUT TO BE CHECKED BY CONTRACTOR

2			
1			
No.	Date	Issue / Revision	Chkd.

Project:
NTA & KCC Bus Shelter Programme 2025
Proposed construction of 1 new Bus Shelters & boarding platforms

Dwg. Title:
Castledermot- Co. Kildare
General Arrangement

Dwg. No.	Rev.	Stage:
2025-BP-B2-10	0	Section 3B
Date:	26/02/2026	Scale: NTS
Drawn:	J.P.	Approved: C.D.B.
		PART VIII
		TENDER
		CONTRACT